

Standard-Zahnscheiben für Taper-Buchsen *Timing belt pulleys for taper bushes*

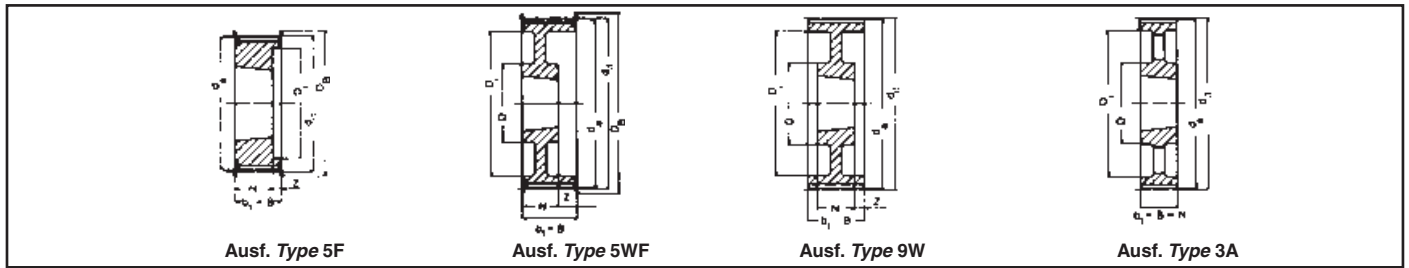

Type L – Teilung *Pitch 9,525 mm für Riemenbreite for belt width 100*

Bezeichnung <i>Part no.</i>	Anzahl der Zähne <i>No. of teeth</i>	Ausführung <i>Type</i>	Material	d_d (mm)	d_a (mm)	D_B (mm)	b_1 (mm)	B (mm)	N (mm)	V (mm)	Z (mm)	D (mm)	D_i (mm)	Taper-Buchse <i>Taper bush</i>	Gewicht ohne Buchse <i>Weight without bush</i> (= kg)
TB 18 L 100	18	5F	St	54,57	53,81	60	31,0	31,0	22,0	—	9,0	—	38	1108	0,2
TB 19 L 100	19	5F	St	57,61	56,84	60	31,0	31,0	22,0	—	9,0	—	38	1108	0,3
TB 20 L 100	20	5F	St	60,64	59,88	66	31,0	31,0	22,0	—	9,0	—	45	1108	0,4
TB 21 L 100	21	5F	St	63,67	62,91	71	31,0	31,0	22,0	—	9,0	—	47	1108	0,4
TB 22 L 100	22	5F	St	66,70	65,94	75	31,0	31,0	22,0	—	9,0	—	51	1108	0,4
TB 23 L 100	23	5F	GG	69,73	68,97	79	32,0	32,0	22,0	—	10,0	—	54	1108	0,5
TB 24 L 100	24	5F	GG	72,77	72,00	79	32,0	32,0	22,0	—	10,0	—	54	1108	0,6
TB 25 L 100	25	5F	GG	75,80	75,04	83	32,0	32,0	22,0	—	10,0	—	56	1108	0,6
TB 26 L 100	26	5F	GG	78,83	78,07	87	32,0	32,0	22,0	—	10,0	—	60	1108	0,7
TB 27 L 100	27	5F	GG	81,86	81,10	87	32,0	32,0	22,0	—	10,0	—	62	1108	0,8
TB 28 L 100	28	5F	GG	84,89	84,13	91	32,0	32,0	22,0	—	10,0	—	65	1108	0,8
TB 30 L 100	30	5F	GG	90,96	90,20	97	32,0	32,0	25,0	—	7,0	—	71	1210	0,9
TB 32 L 100	32	5F	GG	97,02	96,26	103	32,0	32,0	25,0	—	7,0	—	75	1210	1,0
TB 36 L 100	36	5F	GG	109,15	108,39	115	32,0	32,0	25,0	—	7,0	—	89	1610	1,4
TB 40 L 100	40	5F	GG	121,28	120,51	127	32,0	32,0	25,0	—	7,0	—	101	1610	1,7
TB 48 L 100	48	5WF	GG	145,53	144,77	152	32,0	32,0	25,0	—	7,0	92	124	1610	2,7
TB 60 L 100	60	9W	GG	181,91	181,15	—	32,0	32,0	25,0	—	3,5	92	166	1610	2,4
TB 72 L 100	72	3A	GG	218,30	217,53	—	32,0	32,0	32,0	—	—	106	202	2012	4,4
TB 84 L 100	84	3A	GG	254,68	253,90	—	32,0	32,0	32,0	—	—	106	236	2012	6,0
TB 96 L 100	96	3A	GG	291,06	290,30	—	32,0	32,0	32,0	—	—	106	270	2012	7,1
TB 120 L 100	120	3A	GG	363,83	363,07	—	32,0	32,0	32,0	—	—	106	343	2012	8,5

St = Stahl *Steel*
GG = Grauguss *Cast iron*

Fertigungstechnische Änderungen vorbehalten.
We reserve the right to make technical changes.
Bohrungsdurchmesser d_2 siehe Seite 89.
Bore diameters d_2 see page 89.

Taper-Buchse <i>Taper bush</i>	1108	1210	1610	2012
Bohrung d_2 (mm) von ... bis ... <i>Bore d_2 (mm) from ... to ...</i>	10-28	11-32	14-42	14-50

Standard-Zahnscheiben für Taper-Buchsen *Timing belt pulleys for taper bushes*

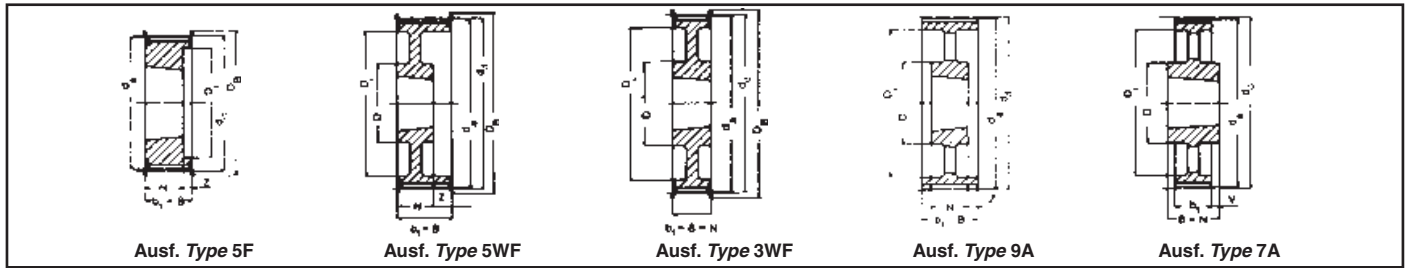

Type H – Teilung *Pitch 12,7 mm für Riemenbreite for belt width 100*

Bezeichnung Part no.	Anzahl der Zähne No. of teeth	Ausführung Type	Material	d_d (mm)	d_a (mm)	D_B (mm)	b_1 (mm)	B (mm)	N (mm)	V (mm)	Z (mm)	D (mm)	D_1 (mm)	Taper-Buchse Taper bush	Gewicht ohne Buchse Weight without bush (= kg)
TB 16 H 100	16	5F	St	64,68	63,31	71	31,0	31,0	22,0	—	9,0	—	45	1108	0,4
TB 18 H 100	18	5F	St	72,77	71,39	79	31,0	31,0	25,0	—	6,0	—	52	1210	0,5
TB 19 H 100	19	5F	St	76,81	75,44	83	31,0	31,0	25,0	—	6,0	—	56	1210	0,6
TB 20 H 100	20	5F	St	80,55	79,48	87	31,0	31,0	25,0	—	6,0	—	60	1210	0,7
TB 21 H 100	21	5F	GG	84,89	83,52	91	32,0	32,0	25,0	—	7,0	—	63	1210	0,8
TB 22 H 100	22	5F	GG	88,94	87,56	93	32,0	32,0	25,0	—	7,0	—	67	1210	0,9
TB 23 H 100	23	5F	GG	92,98	91,61	97	32,0	32,0	25,0	—	7,0	—	71	1610	0,9
TB 24 H 100	24	5F	GG	97,02	95,65	103	32,0	32,0	25,0	—	7,0	—	75	1610	1,0
TB 25 H 100	25	5F	GG	101,06	99,69	106	32,0	32,0	25,0	—	7,0	—	79	1610	1,0
TB 26 H 100	26	5F	GG	105,11	103,73	111	32,0	32,0	25,0	—	7,0	—	83	1610	1,2
TB 27 H 100	27	5F	GG	109,15	107,78	115	32,0	32,0	25,0	—	7,0	—	87	1610	1,3
TB 28 H 100	28	5F	GG	113,19	111,82	119	32,0	32,0	25,0	—	7,0	—	91	1610	1,5
TB 30 H 100	30	5F	GG	121,28	119,90	127	32,0	32,0	25,0	—	7,0	—	99	1610	1,7
TB 32 H 100	32	5WF	GG	129,36	127,99	135	32,0	32,0	25,0	—	7,0	92	108	1610	2,0
TB 36 H 100	36	5WF	GG	145,53	144,16	152	32,0	32,0	25,0	—	7,0	92	124	1610	2,7
TB 40 H 100	40	5WF	GG	161,70	160,33	168	32,0	32,0	25,0	—	7,0	92	140	1610	3,6
TB 44 H 100	44	3WF	GG	177,87	176,50	184	32,0	32,0	32,0	—	—	106	153	2012	3,8
TB 48 H 100	48	3WF	GG	194,04	192,67	200	32,0	32,0	32,0	—	—	106	169	2012	3,2
TB 60 H 100	60	9A	GG	242,55	241,18	—	34,0	34,0	32,0	—	1,0	106	223	2012	4,8
TB 72 H 100	72	9A	GG	291,06	289,69	—	34,0	34,0	32,0	—	1,0	106	270	2012	5,7
TB 84 H 100*	84	9A	GG	339,57	338,20	—	34,0	34,0	32,0	—	1,0	106	318	2012	6,8
TB 96 H 100*	96	7A	GG	388,08	386,71	—	34,0	45,0	45,0	5,5	—	119	366	2517	8,2
TB 120 H 100*	120	7A	GG	485,10	483,73	—	34,0	45,0	45,0	5,5	—	119	462	2517	12,1

Type H – Teilung *Pitch 12,7 mm für Riemenbreite for belt width 150*

TB 18 H 150	18	5F	St	72,77	71,39	79	45,0	45,0	25,0	—	20,0	—	53	1210	0,6
TB 19 H 150	19	5F	St	76,81	75,44	83	45,0	45,0	25,0	—	20,0	—	56	1210	0,7
TB 20 H 150	20	5F	St	80,55	79,48	87	45,0	45,0	25,0	—	20,0	—	60	1210	0,8
TB 21 H 150	21	5F	GG	84,89	83,52	91	45,0	45,0	25,0	—	20,0	—	64	1210	1,0
TB 22 H 150	22	5F	GG	88,94	87,56	93	45,0	45,0	25,0	—	20,0	—	68	1210	1,2
TB 23 H 150	23	5F	GG	92,98	91,61	97	45,0	45,0	25,0	—	20,0	—	71	1610	1,3
TB 24 H 150	24	5F	GG	97,02	95,65	103	45,0	45,0	25,0	—	20,0	—	74	1610	1,2
TB 25 H 150	25	5F	GG	101,06	99,69	106	45,0	45,0	25,0	—	20,0	—	78	1610	1,2
TB 26 H 150	26	5F	GG	105,11	103,73	111	45,0	45,0	25,0	—	20,0	—	82	1610	1,4
TB 27 H 150	27	5F	GG	109,15	107,78	115	45,0	45,0	25,0	—	20,0	—	87	1610	1,6
TB 28 H 150	28	5F	GG	113,19	111,82	119	45,0	45,0	25,0	—	20,0	—	91	1610	1,8
TB 30 H 150	30	5F	GG	121,28	119,90	127	45,0	45,0	25,0	—	20,0	—	99	1610	2,0
TB 32 H 150	32	5WF	GG	129,36	127,99	135	45,0	45,0	25,0	—	20,0	92	108	1610	2,3
TB 36 H 150	36	5WF	GG	145,53	144,16	152	45,0	45,0	25,0	—	20,0	92	124	1610	3,1
TB 40 H 150	40	5WF	GG	161,70	160,33	168	45,0	45,0	25,0	—	20,0	92	140	1610	4,0
TB 44 H 150	44	5WF	GG	177,87	176,50	184	45,0	45,0	32,0	—	13,0	106	153	2012	4,4
TB 48 H 150	48	5WF	GG	194,04	192,67	200	45,0	45,0	32,0	—	13,0	106	169	2012	4,8
TB 60 H 150	60	9A	GG	242,55	241,18	—	46,0	46,0	32,0	—	7,0	106	223	2012	5,4
TB 72 H 150	72	9A	GG	291,06	289,69	—	46,0	46,0	32,0	—	7,0	106	270	2012	6,5
TB 84 H 150*	84	9A	GG	339,57	338,20	—	46,0	46,0	32,0	—	7,0	106	320	2012	8,4
TB 96 H 150*	96	9A	GG	388,08	386,71	—	46,0	46,0	45,0	—	0,5	119	366	2517	11,0
TB 120 H 150*	120	9A	GG	485,10	483,73	—	46,0	46,0	45,0	—	0,5	119	462	2517	14,8

St = Stahl *Steel* – GG = Grauguss *Cast iron*
 Fertigungstechnische Änderungen vorbehalten.
 We reserve the right to make technical changes.

* Keine Lagerware *Non stock items*

Bohrungsdurchmesser d_2 siehe Seite 89.
 Bore diameters d_2 see page 89.

Taper-Buchse Taper bush	1108	1210	1610	2012	2517
Bohrung d_2 (mm) von ... bis ... Bore d_2 (mm) from ... to ...	10-28	11-32	14-42	14-50	16-60

Standard-Zahnscheiben für Taper-Buchsen *Timing belt pulleys for taper bushes*

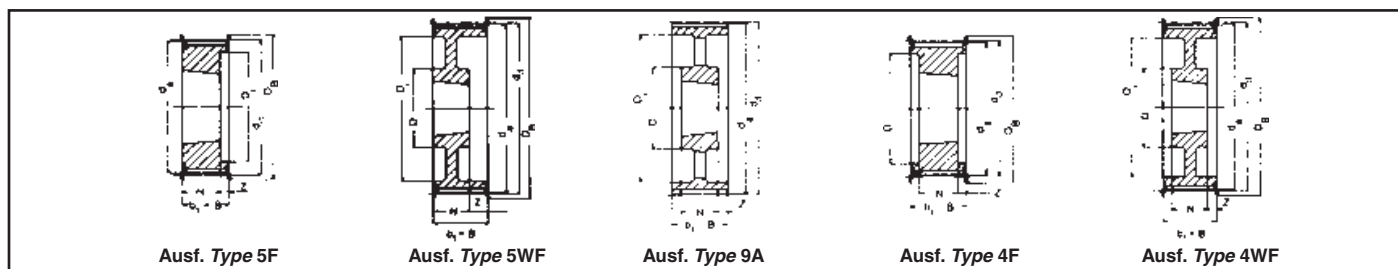

Type H – Teilung *Pitch 12,7 mm für Riemenbreite for belt width 200*

Bezeichnung Part no.	Anzahl der Zähne No. of teeth	Ausführung Type	Material	d_d (mm)	d_a (mm)	D_B (mm)	b_1 (mm)	B (mm)	N (mm)	V (mm)	Z (mm)	D (mm)	D_1 (mm)	Taper-Buchse Taper bush	Gewicht ohne Buchse Weight without bush (= kg)
TB 18 H 200	18	5F	St	72,77	71,39	79	58,0	58,0	25,0	—	33,0	—	52	1210	0,8
TB 19 H 200	19	5F	St	76,81	75,44	83	58,0	58,0	25,0	—	33,0	—	56	1610	0,9
TB 20 H 200	20	5F	St	80,55	79,48	87	58,0	58,0	25,0	—	33,0	—	60	1610	1,0
TB 21 H 200	21	5F	GG	84,89	83,52	91	58,0	58,0	25,0	—	33,0	—	64	1610	1,7
TB 22 H 200	22	5F	GG	88,94	87,56	93	58,0	58,0	25,0	—	33,0	—	68	1610	1,5
TB 23 H 200	23	5F	GG	92,98	91,61	97	58,0	58,0	25,0	—	33,0	—	71	1610	1,8
TB 24 H 200	24	5F	GG	97,02	95,65	103	58,0	58,0	25,0	—	33,0	—	74	1610	1,5
TB 25 H 200	25	5F	GG	101,06	99,69	106	58,0	58,0	25,0	—	33,0	—	78	1610	1,5
TB 26 H 200	26	5F	GG	105,11	103,73	111	58,0	58,0	25,0	—	33,0	—	82	1610	1,8
TB 27 H 200	27	5F	GG	109,15	107,78	115	58,0	58,0	25,0	—	33,0	—	87	1610	1,9
TB 28 H 200	28	5F	GG	113,19	111,82	119	58,0	58,0	25,0	—	33,0	—	91	1610	1,9
TB 30 H 200	30	5F	GG	121,28	119,90	127	58,0	58,0	25,0	—	33,0	—	99	1610	2,3
TB 32 H 200	32	5F	GG	129,36	127,99	135	58,0	58,0	32,0	—	26,0	—	107	2012	3,0
TB 36 H 200	36	5WF	GG	145,53	144,16	152	58,0	58,0	32,0	—	26,0	102	124	2012	3,0
TB 40 H 200	40	5WF	GG	161,70	160,33	168	58,0	58,0	32,0	—	26,0	106	140	2012	3,6
TB 44 H 200	44	5WF	GG	177,87	176,50	184	58,0	58,0	32,0	—	26,0	106	153	2012	4,5
TB 48 H 200	48	5WF	GG	194,04	192,67	200	58,0	58,0	45,0	—	13,0	119	169	2517	4,6
TB 60 H 200	60	9A	GG	242,55	241,18	—	60,0	60,0	45,0	—	7,5	119	223	2517	7,0
TB 72 H 200	72	9A	GG	291,06	289,69	—	60,0	60,0	45,0	—	7,5	119	270	2517	8,0
TB 84 H 200*	84	9A	GG	339,57	338,20	—	60,0	60,0	45,0	—	7,5	119	320	2517	9,0
TB 96 H 200*	96	9A	GG	388,08	386,71	—	60,0	60,0	45,0	—	7,5	119	366	2517	11,5
TB 120 H 200*	120	9A	GG	485,10	483,73	—	60,0	60,0	45,0	—	7,5	119	462	2517	15,4

Type H – Teilung *Pitch 12,7 mm für Riemenbreite for belt width 300*

TB 20 H 300	20	4F	St	80,55	79,48	87	84,0	84,0	38,0	—	23,0	—	65	1615	1,5
TB 21 H 300	21	4F	GG	84,89	83,52	91	84,0	84,0	38,0	—	23,0	—	66	1615	1,2
TB 22 H 300	22	4F	GG	88,94	87,56	93	84,0	84,0	38,0	—	23,0	—	67	1615	1,6
TB 23 H 300	23	4F	GG	92,98	91,61	97	84,0	84,0	38,0	—	23,0	—	71	1615	1,8
TB 24 H 300	24	4F	GG	97,02	95,65	103	84,0	84,0	38,0	—	23,0	—	75	1615	2,1
TB 25 H 300	25	4F	GG	101,06	99,69	106	84,0	84,0	38,0	—	23,0	—	79	1615	2,0
TB 26 H 300	26	4F	GG	105,11	103,73	111	84,0	84,0	38,0	—	23,0	—	83	1615	2,7
TB 27 H 300	27	4F	GG	109,15	107,78	115	84,0	84,0	32,0	—	26,0	—	87	2012	3,0
TB 28 H 300	28	4F	GG	113,19	111,82	119	84,0	84,0	32,0	—	26,0	—	91	2012	2,4
TB 30 H 300	30	4F	GG	121,28	119,90	127	84,0	84,0	32,0	—	26,0	—	99	2012	2,9
TB 32 H 300	32	4F	GG	129,36	127,99	135	84,0	84,0	45,0	—	19,5	—	107	2517	3,3
TB 36 H 300	36	4F	GG	145,53	144,16	152	84,0	84,0	45,0	—	19,5	—	124	2517	4,5
TB 40 H 300	40	4F	GG	161,70	160,33	168	84,0	84,0	45,0	—	19,5	—	137	2517	6,0
TB 44 H 300	44	4WF	GG	177,87	176,50	184	86,0	86,0	45,0	—	20,5	119	153	2517	6,6
TB 48 H 300	48	4WF	GG	194,04	192,67	200	86,0	86,0	45,0	—	20,5	119	169	2517	7,6
TB 60 H 300	60	9A	GG	242,55	241,18	—	86,0	86,0	45,0	—	20,5	119	223	2517	8,4
TB 72 H 300	72	9A	GG	291,06	289,69	—	86,0	86,0	45,0	—	20,5	119	270	2517	10,4
TB 84 H 300*	84	9A	GG	339,57	338,20	—	86,0	86,0	45,0	—	20,5	119	320	2517	12,5
TB 96 H 300*	96	9A	GG	388,08	386,71	—	86,0	86,0	76,0	—	5,0	150	362	3030	14,2
TB 120 H 300*	120	9A	GG	485,10	483,73	—	86,0	86,0	76,0	—	5,0	150	460	3030	18,8

St = Stahl *Steel* – GG = Grauguss *Cast iron*
 Fertigungstechnische Änderungen vorbehalten.
We reserve the right to make technical changes.
 * Keine Lagerware *Non stock items*
 Bohrungsdurchmesser d_2 siehe Seite 89.
Bore diameters d_2 see page 89.

Taper-Buchse Taper bush	1210	1610	1615	2012	2517	3030
Bohrung d_2 (mm) von ... bis ... Bore d_2 (mm) from ... to ...	11-32	14-42	14-42	14-50	16-60	35-75

Standard-Zahnscheiben für Taper-Buchsen *Timing belt pulleys for taper bushes*

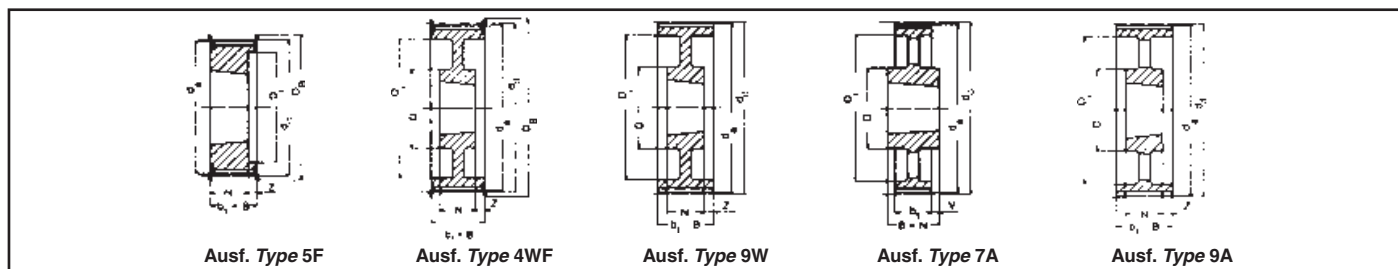

Type XH – Teilung *Pitch 22,225 mm für Riemenbreite for belt width 200*

Bezeichnung Part no.	Anzahl der Zähne No. of teeth	Ausführung Type	Material	d_d (mm)	d_a (mm)	D_B (mm)	b_1 (mm)	B (mm)	N (mm)	V (mm)	Z (mm)	D (mm)	D_i (mm)	Taper-Buchse Taper bush	Gewicht ohne Buchse Weight without bush (= kg)
TB 18 XH 200*	18	5F	GG	127,34	124,55	138	64	64	45	—	20,0	—	95	2517	2,6
TB 20 XH 200*	20	5F	GG	141,49	138,69	154	64	64	45	—	20,0	—	110	2517	3,6
TB 22 XH 200*	22	5F	GG	155,64	152,84	168	64	64	45	—	20,0	—	120	2517	4,8
TB 24 XH 200*	24	5F	GG	169,79	166,69	183	64	64	45	—	20,0	—	135	2517	6,1
TB 26 XH 200*	26	5F	GG	183,94	181,14	198	64	64	45	—	20,0	—	150	2517	7,4
TB 28 XH 200*	28	4WF	GG	198,08	195,29	211	64	64	45	—	10,0	120	165	2517	9,0
TB 30 XH 200*	30	4WF	GG	212,23	209,44	226	64	64	45	—	10,0	120	180	2517	8,6
TB 32 XH 200*	32	4WF	GG	226,38	223,59	240	64	64	45	—	10,0	120	195	2517	9,8
TB 40 XH 200*	40	4WF	GG	282,98	280,18	296	64	64	51	—	6,5	160	245	3020	13,3
TB 48 XH 200*	48	9W	GG	339,57	336,78	—	64	64	51	—	6,5	160	300	3020	19,0

Type XH – Teilung *Pitch 22,225 mm für Riemenbreite for belt width 300*

TB 18 XH 300*	18	5F	GG	127,34	124,55	138	90	90	45	—	45,0	—	95	2517	3,7
TB 20 XH 300*	20	5F	GG	141,49	138,69	154	90	90	45	—	45,0	—	110	2517	4,7
TB 22 XH 300*	22	5F	GG	155,64	152,84	168	90	90	45	—	45,0	—	120	2517	6,0
TB 24 XH 300*	24	5F	GG	169,79	166,69	183	90	90	45	—	45,0	—	135	2517	7,6
TB 26 XH 300*	26	5F	GG	183,94	181,14	198	90	90	45	—	45,0	—	150	2517	9,8
TB 28 XH 300*	28	5F	GG	198,08	195,29	211	90	90	51	—	39,0	—	165	3020	11,6
TB 30 XH 300*	30	5F	GG	212,23	209,44	226	90	90	51	—	39,0	—	180	3020	11,9
TB 32 XH 300*	32	5F	GG	226,38	223,59	240	90	90	51	—	39,0	—	195	3020	13,8
TB 40 XH 300*	40	4WF	GG	282,98	280,18	296	90	90	51	—	19,5	160	245	3020	19,5
TB 48 XH 300*	48	9W	GG	339,57	336,78	—	90	90	51	—	19,5	160	300	3020	27,0

GG = Grauguss Cast iron

Fertigungstechnische Änderungen vorbehalten.
We reserve the right to make technical changes.

* Keine Lagerware Non stock items

Bohrungsdurchmesser d_2 siehe Seite 89.
Bore diameters d_2 see page 89.

Taper-Buchse Taper bush	2517	3020	3535	4040
Bohrung d_2 (mm) von ... bis ... Bore d_2 (mm) from ... to ...	16-60	25-75	35-90	40-100

Standard-Zahnscheiben für Taper-Buchsen *Timing belt pulleys for taper bushes*

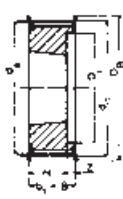

Ausf. Type 5F

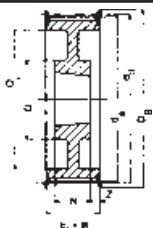

Ausf. Type 4WF

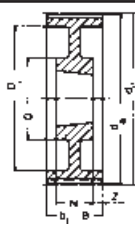

Ausf. Type 9W

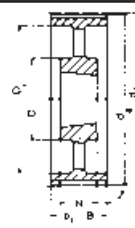

Ausf. Type 9A

Type XH – Teilung *Pitch 22,225 mm für Riemenbreite for belt width 400*

Bezeichnung <i>Part no.</i>	Anzahl der Zähne <i>No. of teeth</i>	Ausführung <i>Type</i>	Material	d_g (mm)	d_a (mm)	D_B (mm)	b_1 (mm)	B (mm)	N (mm)	V (mm)	Z (mm)	D (mm)	D_1 (mm)	Taper-Buchse <i>Taper bush</i>	Gewicht ohne Buchse <i>Weight without bush</i> (= kg)
TB 20 XH 400*	20	5F	GG	141,49	138,69	154	119	119	45	—	74,0	—	110	2517	6,0
TB 22 XH 400*	22	5F	GG	155,64	152,84	168	119	119	45	—	74,0	—	120	2517	7,2
TB 24 XH 400*	24	5F	GG	169,79	166,69	183	119	119	51	—	68,0	—	135	3020	8,4
TB 26 XH 400*	26	5F	GG	183,94	181,14	198	119	119	51	—	68,0	—	150	3020	10,3
TB 28 XH 400*	28	5F	GG	198,08	195,29	211	119	119	51	—	68,0	—	165	3020	12,3
TB 30 XH 400*	30	5F	GG	212,23	209,44	226	119	119	51	—	68,0	—	180	3020	14,3
TB 32 XH 400*	32	5F	GG	226,38	223,59	240	119	119	51	—	68,0	—	195	3020	19,9
TB 40 XH 400*	40	4WF	GG	282,98	280,18	296	119	119	89	—	15,0	190	245	3535	24,6
TB 48 XH 400*	48	9W	GG	339,57	336,78	—	119	119	89	—	15,0	190	300	3535	30,0

GG = Grauguss *Cast iron*

Fertigungstechnische Änderungen vorbehalten.
We reserve the right to make technical changes.

* Keine Lagerware *Non stock items*

Bohrungsdurchmesser d_2 siehe Seite 89.
Bore diameters d_2 see page 89.

Taper-Buchse <i>Taper bush</i>	2517	3020	3535	4040
Bohrung d_2 (mm) von ... bis ... <i>Bore d_2 (mm) from ... to ...</i>	16-60	25-75	35-90	40-100

Standard-Zahnscheiben für zylindrische Bohrung Timing belt pulleys for plain boring

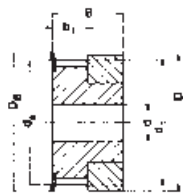

Ausf. Type 1F

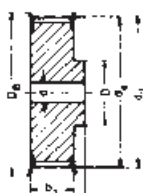

Ausf. Type 6F

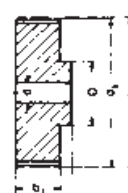

Ausf. Type 6

Type 3M – Teilung Pitch 3 mm für Riemenbreite for belt width 6 mm

Keine Lagerware
Non stock items

Bezeichnung Part no.	Anzahl der Zähne No. of teeth	Aus- führung Type	Material	d _g (mm)	d _a (mm)	D _B (mm)	b ₁ (mm)	B (mm)	D (mm)	Vor- bohrung Pilot bore d (mm)	Fertig- bohrung Finished bore d _{max} (mm)	Gewicht Weight (= kg)
10-3M-6	10	1F	Al	9,55	8,79	13,0	7,2	14,5	13,0	—	3	
12-3M-6	12	1F	Al	11,46	10,70	15,0	7,2	14,5	15,0	—	5	
14-3M-6	14	1F	Al	13,37	12,61	16,0	7,2	14,5	16,0	—	6	
15-3M-6	15	1F	Al	14,32	13,56	17,5	7,2	14,5	17,5	—	6	
16-3M-6	16	6F	Al	15,28	14,52	18,0	9,8	17,5	10,0	4	7	
18-3M-6	18	6F	Al	17,19	16,43	19,5	9,8	17,5	11,0	6	8	
20-3M-6	20	6F	Al	19,10	18,34	23,0	9,8	17,5	13,0	6	9	
21-3M-6	21	6F	Al	20,05	19,29	25,0	9,8	17,5	14,0	6	9	
22-3M-6	22	6F	Al	21,01	20,25	25,0	9,8	17,5	14,0	6	9	
24-3M-6	24	6F	Al	22,92	22,16	25,0	9,8	17,5	14,0	6	9	
26-3M-6	26	6F	Al	24,83	24,07	28,0	9,8	17,5	16,0	6	11	
28-3M-6	28	6F	Al	26,74	25,98	32,0	9,8	17,5	18,0	6	12	
30-3M-6	30	6F	Al	28,65	27,89	32,0	9,8	17,5	20,0	6	14	
32-3M-6	32	6F	Al	30,56	29,80	36,0	9,8	17,5	22,0	6	15	
36-3M-6	36	6F	Al	34,38	33,62	38,0	10,3	18,0	26,0	6	16	
40-3M-6	40	6F	Al	38,20	37,44	42,0	10,3	18,0	28,0	6	18	
44-3M-6	44	6F	Al	42,02	41,26	48,0	10,3	18,0	33,0	6	20	
48-3M-6	48	6	Al	45,84	45,08	—	10,3	18,6	33,0	8	20	
60-3M-6	60	6	Al	57,30	56,54	—	10,3	18,6	33,0	8	20	
72-3M-6	72	6	Al	68,75	67,99	—	10,3	18,6	33,0	8	20	

Type 3M – Teilung Pitch 3 mm für Riemenbreite for belt width 9 mm

10-3M-9	10	1F	Al	9,55	8,79	13,0	10,2	17,5	13,0	—	3	0,004
12-3M-9	12	1F	Al	11,46	10,70	15,0	10,2	17,5	15,0	—	5	0,006
14-3M-9	14	1F	Al	13,37	12,61	16,0	10,2	17,5	16,0	—	6	0,007
15-3M-9	15	1F	Al	14,32	13,56	17,5	10,2	17,5	17,5	—	6	0,008
16-3M-9	16	6F	Al	15,28	14,52	18,0	12,8	20,6	10,0	4	7	0,007
18-3M-9	18	6F	Al	17,19	16,43	19,5	12,8	20,6	11,0	6	8	0,008
20-3M-9	20	6F	Al	19,10	18,34	23,0	12,8	20,6	13,0	6	9	0,010
21-3M-9	21	6F	Al	20,05	19,29	25,0	12,8	20,6	14,0	6	9	0,013
22-3M-9	22	6F	Al	21,01	20,25	25,0	12,8	20,6	14,0	6	9	0,014
24-3M-9	24	6F	Al	22,92	22,16	25,0	12,8	20,6	14,0	6	9	0,016
26-3M-9	26	6F	Al	24,83	24,07	28,0	12,8	20,6	16,0	6	11	0,018
28-3M-9	28	6F	Al	26,74	25,98	32,0	12,8	20,6	18,0	6	12	0,024
30-3M-9	30	6F	Al	28,65	27,89	32,0	12,8	20,6	20,0	6	14	0,028
32-3M-9	32	6F	Al	30,56	29,80	36,0	12,8	20,6	22,0	6	15	0,032
36-3M-9	36	6F	Al	34,38	33,62	38,0	13,4	22,2	26,0	6	16	0,045
40-3M-9	40	6F	Al	38,20	37,44	42,0	13,4	22,2	28,0	6	18	0,055
44-3M-9	44	6F	Al	42,02	41,26	48,0	13,4	22,2	33,0	6	20	0,074
48-3M-9	48	6	Al	45,84	45,08	—	13,4	22,2	33,0	8	20	0,074
60-3M-9	60	6	Al	57,30	56,54	—	13,4	22,2	33,0	8	20	0,106
72-3M-9	72	6	Al	68,75	67,99	—	13,4	22,2	33,0	8	20	0,145

Standard-Zahnscheiben für zylindrische Bohrung Timing belt pulleys for plain boring

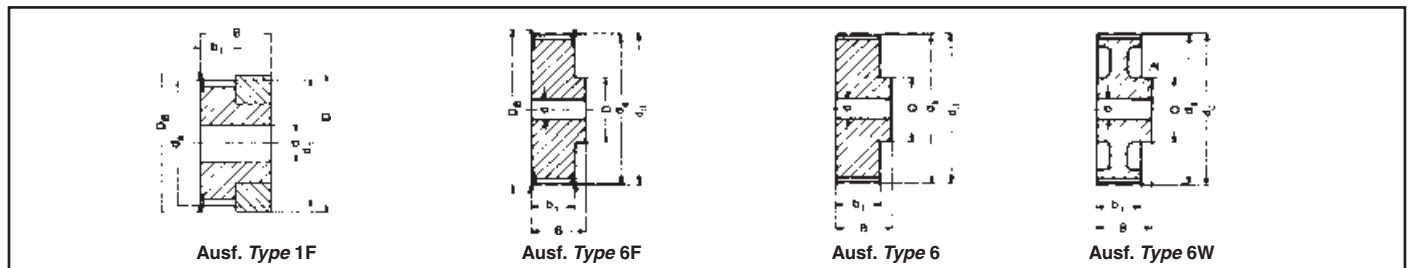

Type 3M – Teilung Pitch 3 mm für Riemenbreite for belt width 15 mm

Bezeichnung Part no.	Anzahl der Zähne No. of teeth	Aus- führung Type	Material	d _d (mm)	d _a (mm)	D _B (mm)	b ₁ (mm)	B (mm)	D (mm)	Vor- bohrung Pilot bore d (mm)	Fertig- bohrung Finished bore d _{max} (mm)	Gewicht Weight (= kg)
10-3M-15	10	1F	Al	9,55	8,79	13,0	17,0	26	13,0	—	3	0,006
12-3M-15	12	1F	Al	11,46	10,70	15,0	17,0	26	15,0	—	5	0,008
14-3M-15	14	1F	Al	13,37	12,61	16,0	17,0	26	16,0	—	6	0,010
15-3M-15	15	1F	Al	14,32	13,56	17,5	17,0	26	17,5	—	6	0,012
16-3M-15	16	6F	Al	15,28	14,52	18,0	19,5	26	10,0	4	7	0,010
18-3M-15	18	6F	Al	17,19	16,43	19,5	19,5	26	11,0	6	8	0,012
20-3M-15	20	6F	Al	19,10	18,34	23,0	19,5	26	13,0	6	9	0,014
21-3M-15	21	6F	Al	20,05	19,29	25,0	19,5	26	14,0	6	9	0,016
22-3M-15	22	6F	Al	21,01	20,25	25,0	19,5	26	14,0	6	9	0,018
24-3M-15	24	6F	Al	22,92	22,16	25,0	19,5	26	14,0	6	9	0,020
26-3M-15	26	6F	Al	24,83	24,07	28,0	19,5	26	16,0	6	11	0,027
28-3M-15	28	6F	Al	26,74	25,98	32,0	19,5	26	18,0	6	12	0,030
30-3M-15	30	6F	Al	28,65	27,89	32,0	19,5	26	20,0	6	14	0,035
32-3M-15	32	6F	Al	30,56	29,80	36,0	19,5	26	22,0	6	15	0,042
36-3M-15	36	6F	Al	34,38	33,62	38,0	20,0	30	26,0	6	16	0,060
40-3M-15	40	6F	Al	38,20	37,44	42,0	20,0	30	28,0	6	18	0,075
44-3M-15	44	6F	Al	42,02	41,26	48,0	20,0	30	33,0	6	20	0,100
48-3M-15	48	6	Al	45,84	45,08	—	20,0	30	33,0	8	20	0,103
60-3M-15	60	6	Al	57,30	56,54	—	20,0	30	33,0	8	20	0,150
72-3M-15	72	6	Al	68,75	67,99	—	20,0	30	33,0	8	20	0,212

Type 5M – Teilung Pitch 5 mm für Riemenbreite for belt width 9 mm

12-5M-9	12	6F	St	19,10	17,96	23	14,5	20,0	13,0	4	7	0,028
14-5M-9	14	6F	St	22,28	21,14	25	14,5	20,0	14,0	6	8	0,034
15-5M-9	15	6F	St	23,87	22,73	28	14,5	20,0	16,0	6	10	0,042
16-5M-9	16	6F	St	25,46	24,32	28	14,5	20,0	16,5	6	10	0,050
18-5M-9	18	6F	St	28,65	27,51	32	14,5	20,0	20,0	6	12	0,070
20-5M-9	20	6F	St	31,83	30,69	36	14,5	22,5	23,0	6	14	0,094
21-5M-9	21	6F	St	33,42	32,28	38	14,5	22,5	24,0	6	14	0,110
22-5M-9	22	6F	St	35,01	33,87	38	14,5	22,5	25,5	6	14	0,118
24-5M-9	24	6F	St	38,20	37,06	42	14,5	22,5	27,0	6	16	0,145
26-5M-9	26	6F	St	41,38	40,24	44	14,5	22,5	30,0	6	18	0,170
28-5M-9	28	6F	St	44,56	43,42	48	14,5	22,5	30,5	6	18	0,200
30-5M-9	30	6F	St	47,75	46,61	51	14,5	22,5	35,0	6	20	0,236
32-5M-9	32	6F	St	50,93	49,79	54	14,5	22,5	38,0	8	22	0,270
36-5M-9	36	6F	St	57,30	56,16	60	14,5	22,5	38,0	8	22	0,324
40-5M-9	40	6F	St	63,66	62,52	71	14,5	22,5	38,0	8	22	0,400
44-5M-9	44	6W	Al	70,03	68,89	—	14,5	25,5	38,0	8	22	0,170
48-5M-9	48	6W	Al	76,39	75,25	—	14,5	25,5	45,0	8	25	0,182
60-5M-9	60	6W	Al	95,49	94,35	—	14,5	25,5	45,0	8	25	0,230
72-5M-9	72	6W	Al	114,59	113,45	—	14,5	25,5	45,0	8	25	0,270

Standard-Zahnscheiben für zylindrische Bohrung Timing belt pulleys for plain boring

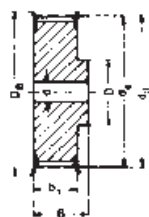

Ausf. Type 6F

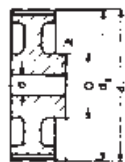

Ausf. Type 6W



Ausf. Type 6

Type 5M – Teilung Pitch 5 mm für Riemenbreite for belt width 15 mm

Bezeichnung Part no.	Anzahl der Zähne No. of teeth	Aus- führung Type	Material	d _b (mm)	d _a (mm)	D _B (mm)	b ₁ (mm)	B (mm)	D (mm)	Vor- bohrung Pilot bore d (mm)	Fertig- bohrung Finished bore d _{max} (mm)	Gewicht Weight (= kg)
12-5M-15	12	6F	St	19,10	17,96	25	20,5	26	13,0	4	7	0,034
14-5M-15	14	6F	St	22,28	21,14	25	20,5	26	14,0	6	8	0,046
15-5M-15	15	6F	St	23,87	22,73	28	20,5	26	16,0	6	10	0,056
16-5M-15	16	6F	St	25,46	24,32	28	20,5	26	16,5	6	10	0,064
18-5M-15	18	6F	St	28,65	27,51	32	20,5	26	20,0	6	12	0,086
20-5M-15	20	6F	St	31,83	30,69	36	20,5	26	23,0	6	14	0,112
21-5M-15	21	6F	St	33,42	32,28	38	20,5	26	24,0	6	14	0,130
22-5M-15	22	6F	St	35,01	33,87	38	20,5	26	25,5	6	14	0,140
24-5M-15	24	6F	St	38,20	37,06	42	20,5	28	27,0	6	16	0,180
26-5M-15	26	6F	St	41,38	40,24	44	20,5	28	30,0	6	18	0,220
28-5M-15	28	6F	St	44,56	43,42	48	20,5	28	30,5	6	18	0,250
30-5M-15	30	6F	St	47,75	46,61	51	20,5	28	35,0	6	20	0,300
32-5M-15	32	6F	St	50,93	49,79	54	20,5	28	38,0	8	22	0,350
36-5M-15	36	6F	St	57,30	56,16	60	20,5	28	38,0	8	22	0,426
40-5M-15	40	6F	St	63,66	62,52	71	20,5	28	38,0	8	22	0,520
44-5M-15	44	6W	Al	70,03	68,89	—	20,5	30	38,0	8	22	0,225
48-5M-15	48	6W	Al	76,39	75,25	—	20,5	30	38,0	8	25	0,187
60-5M-15	60	6W	Al	95,49	94,35	—	20,5	30	50,0	8	25	0,305
72-5M-15	72	6W	Al	114,59	113,45	—	20,5	30	50,0	8	25	0,375

Type 5M – Teilung Pitch 5 mm für Riemenbreite for belt width 25 mm

12-5M-25	12	6F	St	19,10	17,96	25	30	36	13,0	4	7	0,050
14-5M-25	14	6F	St	22,28	21,14	25	30	36	14,0	6	8	0,070
15-5M-25	15	6F	St	23,87	22,73	28	30	36	16,0	6	10	0,080
16-5M-25	16	6F	St	25,46	24,32	28	30	36	16,5	6	10	0,100
18-5M-25	18	6F	St	28,65	27,51	32	30	36	20,0	6	12	0,120
20-5M-25	20	6F	St	31,83	30,69	36	30	36	23,0	6	14	0,160
21-5M-25	21	6F	St	33,42	32,28	38	30	38	24,0	6	14	0,190
22-5M-25	22	6F	St	35,01	33,87	38	30	38	25,5	6	14	0,210
24-5M-25	24	6F	St	38,20	37,06	42	30	38	27,0	6	16	0,250
26-5M-25	26	6F	St	41,38	40,24	44	30	38	30,0	6	18	0,300
28-5M-25	28	6F	St	44,56	43,42	48	30	38	30,5	6	18	0,350
30-5M-25	30	6F	St	47,75	46,61	51	30	38	35,0	6	20	0,420
32-5M-25	32	6F	St	50,93	49,79	54	30	38	38,0	8	22	0,480
36-5M-25	36	6F	St	57,30	56,16	60	30	38	38,0	8	22	0,590
40-5M-25	40	6F	St	63,66	62,52	71	30	38	38,0	8	22	0,740
44-5M-25	44	6W	Al	70,03	68,89	—	30	40	38,0	8	22	0,320
48-5M-25	48	6W	Al	76,39	75,25	—	30	40	38,0	8	25	0,275
60-5M-25	60	6W	Al	95,49	94,35	—	30	40	50,0	8	25	0,435
72-5M-25	72	6W	Al	114,59	113,45	—	30	40	50,0	8	25	0,525

**Standard-Zahnscheiben für zylindrische Bohrung Timing
belt pulleys for plain boring**

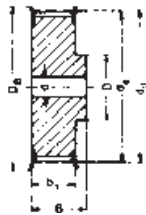

Ausf. Type 6F

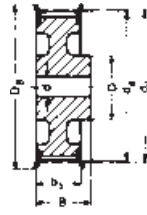

Ausf. Type 6WF

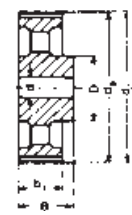

Ausf. Type 6A

Type 8M – Teilung Pitch 8 mm für Riemenbreite for belt width 20 mm

Bezeichnung Part no.	Anzahl der Zähne No. of teeth	Aus- führung Type	Material	d _d (mm)	d _a (mm)	D _B (mm)	b ₁ (mm)	B (mm)	D (mm)	D _i (mm)	Vor- bohrung Pilot bore d (mm)	Fertig- bohrung Finished bore d _{max} (mm)	Gewicht Weight (≈ kg)
22-8M-20	22	6F	St	56,02	54,65	60,0	28	38	43	—	12	30	0,54
24-8M-20	24	6F	St	61,12	59,75	66,0	28	38	45	—	12	30	0,65
26-8M-20	26	6F	St	66,21	64,84	71,0	28	38	50	—	12	35	0,80
28-8M-20	28	6F	St	71,30	70,08	75,0	28	38	50	—	15	35	0,87
30-8M-20	30	6F	St	76,39	75,13	83,0	28	38	55	—	15	35	1,02
32-8M-20	32	6F	St	81,49	80,16	87,0	28	38	60	—	15	40	1,20
34-8M-20	34	6F	St	86,58	85,22	91,0	28	38	70	—	15	45	1,40
36-8M-20	36	6F	St	91,67	90,30	98,5	28	38	70	—	15	45	1,55
38-8M-20	38	6F	St	96,77	95,39	103,0	28	38	75	—	15	45	1,65
40-8M-20	40	6F	GG	101,86	100,49	106,0	28	38	75	—	15	45	1,80
44-8M-20	44	6F	GG	112,05	110,67	119,0	28	38	75	—	15	45	2,10
48-8M-20	48	6F	GG	122,23	120,86	127,0	28	38	75	—	15	45	2,44
56-8M-20	56	6WF	GG	142,60	141,23	148,0	28	38	80	117	15	45	2,60
64-8M-20	64	6WF	GG	162,97	161,60	168,0	28	38	80	137	15	45	2,90
72-8M-20	72	6WF	GG	183,35	181,97	192,0	28	38	80	158	15	45	3,10
80-8M-20	80	6A	GG	203,72	202,35	—	28	38	90	180	15	50	3,80
90-8M-20	90	6A	GG	229,18	227,81	—	28	38	90	204	15	50	4,20
112-8M-20	112	6A	GG	285,21	283,83	—	28	38	90	260	18	50	5,20
144-8M-20	144	6A	GG	366,69	365,32	—	28	38	90	341	20	50	7,50
168-8M-20	168	6A	GG	427,81	426,44	—	28	38	100	402	20	55	10,00
192-8M-20	192	6A	GG	488,92	487,55	—	28	38	100	463	20	55	14,40

Type 8M – Teilung Pitch 8 mm für Riemenbreite for belt width 30 mm

22-8M-30	22	6F	St	56,02	54,65	60,0	38	48	43	—	12	30	0,69
24-8M-30	24	6F	St	61,12	59,75	66,0	38	48	45	—	12	30	0,84
26-8M-30	26	6F	St	66,21	64,84	71,0	38	48	50	—	12	35	1,00
28-8M-30	28	6F	St	71,30	70,08	75,0	38	48	50	—	15	35	1,12
30-8M-30	30	6F	St	76,39	75,13	83,0	38	48	55	—	15	35	1,32
32-8M-30	32	6F	St	81,49	80,16	87,0	38	48	60	—	15	40	1,50
34-8M-30	34	6F	St	86,58	85,22	91,0	38	48	70	—	15	45	1,80
36-8M-30	36	6F	St	91,67	90,30	98,5	38	48	70	—	15	45	1,99
38-8M-30	38	6F	St	96,77	95,39	103,0	38	48	75	—	15	45	2,27
40-8M-30	40	6F	GG	101,86	100,49	106,0	38	48	75	—	15	45	2,40
44-8M-30	44	6F	GG	112,05	110,67	119,0	38	48	75	—	15	45	2,80
48-8M-30	48	6F	GG	122,23	120,86	127,0	38	48	75	—	15	45	3,20
56-8M-30	56	6WF	GG	142,60	141,23	148,0	38	48	90	117	15	50	3,60
64-8M-30	64	6WF	GG	162,97	161,60	168,0	38	48	90	137	15	50	4,30
72-8M-30	72	6WF	GG	183,35	181,97	192,0	38	48	95	158	15	50	4,80
80-8M-30	80	6A	GG	203,72	202,35	—	38	48	100	180	15	55	5,10
90-8M-30	90	6A	GG	229,18	227,81	—	38	48	100	204	15	55	5,70
112-8M-30	112	6A	GG	285,21	283,83	—	38	48	100	260	18	55	6,80
144-8M-30	144	6A	GG	366,69	365,32	—	38	48	100	341	20	55	9,30
168-8M-30	168	6A	GG	427,81	426,44	—	38	48	100	402	20	55	11,40
192-8M-30	192	6A	GG	488,92	487,55	—	38	48	100	463	20	55	16,00

Standard-Zahnscheiben für zylindrische Bohrung Timing belt pulleys for plain boring

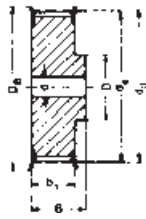

Ausf. Type 6F

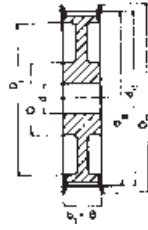

Ausf. Type 10WF



Ausf. Type 10A

Type 8M – Teilung Pitch 8 mm für Riemenbreite for belt width 50 mm

Bezeichnung Part no.	Anzahl der Zähne No. of teeth	Aus- führung Type	Material	d _d (mm)	d _a (mm)	D _B (mm)	b ₁ (mm)	B (mm)	D (mm)	D _i (mm)	Vor- bohrung Pilot bore d (mm)	Fertig- bohrung Finished bore d _{max} (mm)	Gewicht Weight (≈ kg)
22-8M-50	22	6F	St	56,02	54,65	60,0	60	70	43	—	12	30	1,00
24-8M-50	24	6F	St	61,12	59,75	66,0	60	70	45	—	12	30	1,20
26-8M-50	26	6F	St	66,21	64,84	71,0	60	70	50	—	12	35	1,50
28-8M-50	28	6F	St	71,30	70,08	75,0	60	70	50	—	15	35	1,67
30-8M-50	30	6F	St	76,39	75,13	83,0	60	70	55	—	15	35	1,97
32-8M-50	32	6F	St	81,49	80,16	87,0	60	70	60	—	15	40	2,27
34-8M-50	34	6F	St	86,58	85,22	91,0	60	70	70	—	15	45	2,69
36-8M-50	36	6F	St	91,67	90,30	98,5	60	70	70	—	15	45	2,97
38-8M-50	38	6F	St	96,77	95,39	103,0	60	70	75	—	15	45	3,23
40-8M-50	40	6F	GG	101,86	100,49	106,0	60	70	75	—	18	45	3,50
44-8M-50	44	6F	GG	112,05	110,67	119,0	60	70	75	—	18	45	3,90
48-8M-50	48	6F	GG	122,23	120,86	127,0	60	70	80	—	18	45	4,30
56-8M-50	56	10WF	GG	142,60	141,23	148,0	60	60	90	117	18	50	5,00
64-8M-50	64	10WF	GG	162,97	161,60	168,0	60	60	100	137	18	55	5,60
72-8M-50	72	10WF	GG	183,35	181,97	192,0	60	60	100	158	18	55	6,80
80-8M-50	80	10A	GG	203,72	202,35	—	60	60	110	180	18	60	6,90
90-8M-50	90	10A	GG	229,18	227,81	—	60	60	110	204	18	60	8,60
112-8M-50	112	10A	GG	285,21	283,83	—	60	60	110	260	18	60	9,60
144-8M-50	144	10A	GG	366,69	365,32	—	60	60	110	341	20	60	13,80
168-8M-50	168	10A	GG	427,81	426,44	—	60	60	120	402	20	65	16,00
192-8M-50	192	10A	GG	488,92	487,55	—	60	60	130	463	20	70	22,40

Type 8M – Teilung Pitch 8 mm für Riemenbreite for belt width 85 mm

22-8M-85	22	6F	St	56,02	54,65	60,0	95	105	43	—	12	30	1,55
24-8M-85	24	6F	St	61,12	59,75	66,0	95	105	45	—	12	30	1,90
26-8M-85	26	6F	St	66,21	64,84	71,0	95	105	50	—	12	35	2,25
28-8M-85	28	6F	St	71,30	70,08	75,0	95	105	50	—	15	35	2,55
30-8M-85	30	6F	St	76,39	75,13	83,0	95	105	55	—	15	35	3,00
32-8M-85	32	6F	St	81,49	80,16	87,0	95	105	60	—	15	40	3,57
34-8M-85	34	6F	St	86,58	85,22	91,0	95	105	70	—	15	45	4,00
36-8M-85	36	6F	St	91,67	90,30	98,5	95	105	70	—	15	45	4,50
38-8M-85	38	6F	St	96,77	95,39	103,0	95	105	75	—	15	45	4,90
40-8M-85	40	6F	GG	101,86	100,49	106,0	95	105	75	—	18	45	5,20
44-8M-85	44	6F	GG	112,05	110,67	119,0	95	105	75	—	18	45	6,60
48-8M-85	48	6F	GG	122,23	120,86	127,0	95	105	80	—	18	45	7,60
56-8M-85	56	6F	GG	142,60	141,23	148,0	95	105	80	—	20	50	9,80
64-8M-85	64	10WF	GG	162,97	161,60	168,0	95	95	100	137	20	55	10,40
72-8M-85	72	10WF	GG	183,35	181,97	192,0	95	95	110	158	20	60	11,40
80-8M-85	80	10A	GG	203,72	202,35	—	95	95	110	180	20	60	11,10
90-8M-85	90	10A	GG	229,18	227,81	—	95	95	110	204	20	60	13,20
112-8M-85	112	10A	GG	285,21	283,83	—	95	95	110	260	24	60	16,30
144-8M-85*	144	10A	GG	366,69	365,32	—	95	95	120	341	24	65	21,50
168-8M-85*	168	10A	GG	427,81	426,44	—	95	95	120	402	24	65	26,10
192-8M-85*	192	10A	GG	488,92	487,55	—	95	95	130	463	24	70	30,60

Standard-Zahnscheiben für zylindrische Bohrung Timing belt pulleys for plain boring

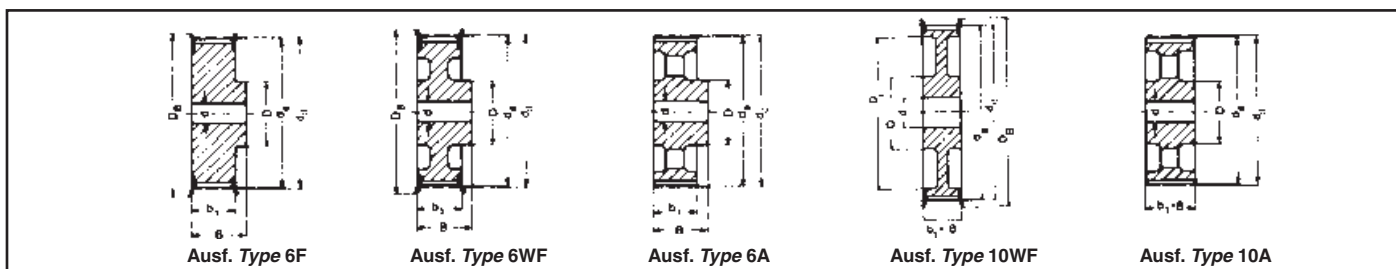

Type 14M – Teilung Pitch 14 mm für Riemenbreite for belt width 40 mm

Bezeichnung Part no.	Anzahl der Zähne No. of teeth	Aus- führung Type	Material	d _d (mm)	d _a (mm)	D _B (mm)	b ₁ (mm)	B (mm)	D (mm)	D _i (mm)	Vor- bohrung Pilot bore d (mm)	Fertig- bohrung Finished bore d _{max} (mm)	Gewicht Weight (≈ kg)
28-14M-40	28	6F	GG	124,78	122,12	127	54	69	100	—	24	60	4,73
29-14M-40	29	6F	GG	129,23	126,57	138	54	69	100	—	24	60	5,09
30-14M-40	30	6F	GG	133,69	130,99	138	54	69	100	—	24	60	5,45
32-14M-40	32	6F	GG	142,60	139,88	154	54	69	100	—	24	70	6,17
34-14M-40	34	6F	GG	151,52	148,79	160	54	69	100	—	24	70	6,88
36-14M-40	36	6F	GG	160,43	157,68	168	54	69	100	—	24	70	7,60
38-14M-40	38	6F	GG	169,34	166,60	183	54	69	120	—	24	70	8,28
40-14M-40	40	6F	GG	178,25	175,49	188	54	69	120	—	24	70	9,26
44-14M-40	44	6F	GG	196,08	193,28	211	54	69	120	—	24	70	10,32
48-14M-40	48	6WF	GG	213,90	211,11	226	54	69	135	172	24	70	11,50
56-14M-40	56	6WF	GG	249,55	246,76	256	54	69	135	207	28	70	13,05
64-14M-40	64	6WF	GG	285,21	282,41	296	54	69	135	242	28	70	14,40
72-14M-40	72	6A	GG	320,86	318,06	—	54	69	135	278	28	70	16,90
80-14M-40	80	6A	GG	356,51	353,71	—	54	69	135	314	28	70	18,50
90-14M-40	90	6A	GG	401,07	398,28	—	54	69	135	358	28	70	20,00
112-14M-40*	112	6A	GG	499,11	496,32	—	54	69	135	456	28	70	26,70
144-14M-40*	144	6A	GG	641,71	638,92	—	54	69	135	600	28	70	35,00
168-14M-40*	168	6A	GG	748,66	745,87	—	54	69	135	706	28	70	44,20
192-14M-40*	192	6A	GG	855,62	852,82	—	54	69	135	813	28	70	52,20
216-14M-40*	216	6A	GG	962,57	959,77	—	54	69	150	920	28	80	60,00

Type 14M – Teilung Pitch 14 mm für Riemenbreite for belt width 55 mm

28-14M-55	28	6F	GG	124,78	122,12	127	70	85	100	—	24	60	5,60
29-14M-55	29	6F	GG	129,23	126,57	138	70	85	100	—	24	60	6,10
30-14M-55	30	6F	GG	133,69	130,99	138	70	85	100	—	24	60	6,60
32-14M-55	32	6F	GG	142,60	139,88	154	70	85	100	—	24	70	7,60
34-14M-55	34	6F	GG	151,52	148,79	160	70	85	100	—	24	70	8,60
36-14M-55	36	6F	GG	160,43	157,68	168	70	85	100	—	24	70	9,60
38-14M-55	38	6F	GG	169,34	166,60	183	70	85	120	—	24	70	10,80
40-14M-55	40	6F	GG	178,25	175,49	188	70	85	120	—	24	70	11,20
44-14M-55	44	6F	GG	196,08	193,28	211	70	85	120	—	24	70	12,50
48-14M-55	48	10WF	GG	213,90	211,11	226	70	70	135	172	24	70	13,70
56-14M-55	56	10WF	GG	249,55	246,76	256	70	70	135	207	28	70	14,50
64-14M-55	64	10WF	GG	285,21	282,41	296	70	70	135	242	28	70	15,60
72-14M-55	72	10A	GG	320,86	318,06	—	70	70	135	278	28	70	18,50
80-14M-55	80	10A	GG	356,51	353,71	—	70	70	135	314	28	70	20,00
90-14M-55	90	10A	GG	401,07	398,28	—	70	70	135	358	28	70	22,60
112-14M-55*	112	10A	GG	499,11	496,32	—	70	70	135	456	28	70	29,50
144-14M-55*	144	10A	GG	641,71	638,92	—	70	70	135	600	28	70	39,00
168-14M-55*	168	10A	GG	748,66	745,87	—	70	70	135	706	28	70	48,50
192-14M-55*	192	10A	GG	855,62	852,82	—	70	70	135	813	28	70	57,80
216-14M-55*	216	10A	GG	962,57	959,77	—	70	70	150	920	28	80	67,00

Standard-Zahnscheiben für zylindrische Bohrung Timing belt pulleys for plain boring

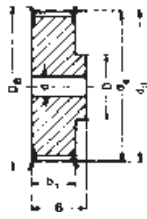

Ausf. Type 6F

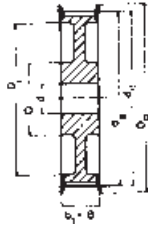

Ausf. Type 10WF



Ausf. Type 10A

Type 14M – Teilung Pitch 14 mm für Riemenbreite for belt width 85 mm

Bezeichnung Part no.	Anzahl der Zähne No. of teeth	Aus- führung Type	Material	d_d (mm)	d_a (mm)	D_B (mm)	b_1 (mm)	B (mm)	D (mm)	D_i (mm)	Vor- bohrung Pilot bore d (mm)	Fertig- bohrung Finished bore d_{max} (mm)	Gewicht Weight (≈ kg)
28-14M-85	28	6F	GG	124,78	122,12	127	102	117	100	—	24	60	7,70
29-14M-85	29	6F	GG	129,23	126,57	138	102	117	100	—	24	60	8,40
30-14M-85	30	6F	GG	133,69	130,99	138	102	117	100	—	24	60	9,10
32-14M-85	32	6F	GG	142,60	139,88	154	102	117	100	—	24	60	10,50
34-14M-85	34	6F	GG	151,52	148,79	160	102	117	100	—	24	70	11,90
36-14M-85	36	6F	GG	160,43	157,68	168	102	117	100	—	32	70	13,20
38-14M-85	38	6F	GG	169,34	166,60	183	102	117	120	—	32	70	15,15
40-14M-85	40	6F	GG	178,25	175,49	188	102	117	135	—	32	70	17,10
44-14M-85	44	6F	GG	196,08	193,28	211	102	117	135	—	32	70	23,30
48-14M-85	48	6F	GG	213,90	211,11	226	102	117	150	—	32	80	25,00
56-14M-85	56	10WF	GG	249,55	246,76	256	102	102	150	207	32	80	25,00
64-14M-85	64	10WF	GG	285,21	282,41	296	102	102	150	242	32	80	28,20
72-14M-85	72	10A	GG	320,86	318,06	—	102	102	150	278	32	80	28,80
80-14M-85	80	10A	GG	356,51	353,71	—	102	102	150	314	32	80	30,10
90-14M-85	90	10A	GG	401,07	398,28	—	102	102	150	358	32	80	33,00
112-14M-85*	112	10A	GG	499,11	496,32	—	102	102	150	456	32	80	41,80
144-14M-85*	144	10A	GG	641,71	638,92	—	102	102	150	600	32	80	52,40
168-14M-85*	168	10A	GG	748,66	745,87	—	102	102	150	706	32	80	60,30
192-14M-85*	192	10A	GG	855,62	852,82	—	102	102	165	813	32	90	70,20
216-14M-85*	216	10A	GG	962,57	959,77	—	102	102	165	920	32	90	81,00

Type 14M – Teilung Pitch 14 mm für Riemenbreite for belt width 115 mm

28-14M-115	28	6F	GG	124,78	122,12	127	133	148	100	—	32	60	9,20
29-14M-115	29	6F	GG	129,23	126,57	138	133	148	100	—	32	60	10,20
30-14M-115	30	6F	GG	133,69	130,99	138	133	148	100	—	32	60	11,20
32-14M-115	32	6F	GG	142,60	139,88	154	133	148	100	—	32	60	13,20
34-14M-115	34	6F	GG	151,52	148,79	160	133	148	100	—	32	70	14,80
36-14M-115	36	6F	GG	160,43	157,68	168	133	148	120	—	32	70	16,60
38-14M-115	38	6F	GG	169,34	166,60	183	133	148	120	—	32	70	19,20
40-14M-115	40	6F	GG	178,25	175,49	188	133	148	135	—	32	70	22,10
44-14M-115	44	6F	GG	196,08	193,28	211	133	148	140	—	32	80	28,00
48-14M-115	48	6F	GG	213,90	211,11	226	133	148	150	—	32	80	35,00
56-14M-115	56	6F	GG	249,55	246,76	256	133	148	150	—	32	80	44,20
64-14M-115	64	10WF	GG	285,21	282,41	296	133	133	150	242	32	80	36,80
72-14M-115	72	10A	GG	320,86	318,06	—	133	133	150	278	32	80	36,10
80-14M-115	80	10A	GG	356,51	353,71	—	133	133	150	314	32	80	38,60
90-14M-115	90	10A	GG	401,07	398,28	—	133	133	150	358	32	80	41,00
112-14M-115*	112	10A	GG	499,11	496,32	—	133	133	150	456	32	80	54,40
144-14M-115*	144	10A	GG	641,71	638,92	—	133	133	165	600	32	90	67,80
168-14M-115*	168	10A	GG	748,66	745,87	—	133	133	165	706	32	90	75,80
192-14M-115*	192	10A	GG	855,62	852,82	—	133	133	165	813	32	90	88,30
216-14M-115*	216	10A	GG	962,57	959,77	—	133	133	165	920	32	90	98,00

**Standard-Zahnscheiben für zylindrische Bohrung Timing
belt pulleys for plain boring**

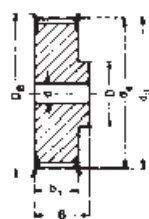

Ausf. Type 6F



Ausf. Type 10W



Ausf. Type 10A

Type 14M – Teilung Pitch 14 mm für Riemenbreite for belt width 170 mm

Bezeichnung Part no.	Anzahl der Zähne No. of teeth	Aus- führung Type	Material	d _d (mm)	d _a (mm)	D _B (mm)	b ₁ (mm)	B (mm)	D (mm)	D _i (mm)	Vor- bohrung Pilot bore d (mm)	Fertig- bohrung Finished bore d _{max} (mm)	Gewicht Weight (≈ kg)
28-14M-170*	28	6F	GG	124,78	122,12	127	187	202	100	—	32	60	13,80
29-14M-170*	29	6F	GG	129,23	126,57	138	187	202	100	—	32	60	14,20
30-14M-170*	30	6F	GG	133,69	130,99	138	187	202	100	—	32	60	15,60
32-14M-170*	32	6F	GG	142,60	139,88	154	187	202	100	—	32	60	18,10
34-14M-170*	34	6F	GG	151,52	148,79	160	187	202	100	—	32	60	20,40
36-14M-170*	36	6F	GG	160,43	157,68	168	187	202	120	—	32	70	23,50
38-14M-170*	38	6F	GG	169,34	166,60	183	187	202	135	—	32	70	26,50
40-14M-170*	40	6F	GG	178,25	175,49	188	187	202	140	—	32	85	30,10
44-14M-170*	44	6F	GG	196,08	193,28	211	187	202	160	—	32	85	37,80
48-14M-170*	48	6F	GG	213,90	211,11	226	187	202	160	—	32	85	44,50
56-14M-170*	56	6F	GG	249,55	246,76	256	187	202	160	—	32	85	61,00
64-14M-170*	64	6F	GG	285,21	282,41	296	187	202	180	—	32	100	81,00
72-14M-170*	72	10W	GG	320,86	318,06	—	187	187	180	278	32	100	61,40
80-14M-170*	80	10W	GG	356,51	353,71	—	187	187	180	314	32	100	65,00
90-14M-170*	90	10A	GG	401,07	398,28	—	187	187	180	358	38	100	68,00
112-14M-170*	112	10A	GG	499,11	496,32	—	187	187	200	456	38	110	87,50
144-14M-170*	144	10A	GG	641,71	638,92	—	187	187	220	600	38	120	114,80
168-14M-170*	168	10A	GG	748,66	745,87	—	187	187	220	706	38	120	125,00
192-14M-170*	192	10A	GG	855,62	852,82	—	187	187	220	813	38	120	136,40
216-14M-170*	216	10A	GG	962,57	959,77	—	187	187	220	920	38	120	147,00

**HTD®-Zahnscheiben Type 20M auf Anfrage
HTD® Pulleys type 20M on request**

Standard-Zahnscheiben für Taper-Buchsen *Timing belt pulleys for taper bushes*

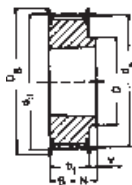

Ausf. Type 8F



Ausf. Type 7a

Type 5M – Teilung *Pitch 5 mm für Riemenbreite for belt width 15 mm*

Bezeichnung <i>Part no.</i>	Anzahl der Zähne <i>No. of teeth</i>	Ausführung <i>Type</i>	Material	d_d (mm)	d_a (mm)	D_B (mm)	b_1 (mm)	B (mm)	N (mm)	V (mm)	Z (mm)	D (mm)	D_1 (mm)	Taper-Buchse <i>Taper bush</i>	Gewicht ohne Buchse <i>Weight without bush</i> (= kg)
TB 34-5M-15	34	8F	St	54,11	52,97	57,0	20,5	22	22	1,5	—	43	—	1008	0,190
TB 36-5M-15	36	8F	St	57,30	56,16	60,0	20,5	22	22	1,5	—	44	—	1108	0,200
TB 38-5M-15	38	8F	St	69,48	59,34	66,0	20,5	22	22	1,5	—	48	—	1108	0,250
TB 40-5M-15	40	8F	St	63,66	62,52	71,0	20,5	22	22	1,5	—	52	—	1108	0,310
TB 44-5M-15	44	8F	St	70,03	68,89	75,0	20,5	22	22	1,5	—	54	—	1108	0,400
TB 48-5M-15	48	8F	St	76,39	75,25	83,0	20,5	25	25	4,5	—	64	—	1210	0,450
TB 56-5M-15	56	8F	GG	89,13	87,99	93,0	20,5	25	25	4,5	—	70	—	1210	0,670
TB 64-5M-15	64	8F	GG	101,86	100,72	106,0	20,5	25	25	4,5	—	78	—	1210	0,960
TB 72-5M-15	72	8F	GG	114,59	113,45	119,0	20,5	25	25	4,5	—	90	—	1610	1,190
TB 80-5M-15	80	8F	GG	127,32	126,18	135,0	20,5	25	25	4,5	—	92	—	1610	1,570
TB 90-5M-15	90	7A	GG	143,24	142,10	—	20,5	25	25	2,3	—	92	—	1610	1,147
TB 112-5M-15	112	7A	GG	178,25	177,11	—	20,5	25	25	2,3	—	92	—	1610	1,940
TB 136-5M-15	136	7A	GG	216,45	215,31	—	20,5	32	32	5,8	—	106	—	2012	3,060
TB 150-5M-15	150	7A	GG	238,73	237,59	—	20,5	32	32	5,8	—	106	—	2012	3,900

GG = Grauguss *Cast iron*
St = Stahl *Steel*

Fertigungstechnische Änderungen vorbehalten.
We reserve the right to make technical changes.
Bohrungsdurchmesser d_2 siehe Seite 89.
Bore diameters d_2 see page 89.

Taper-Buchse <i>Taper bush</i>	1008	1108	1210	1610	2012
Bohrung d_2 (mm) von ... bis ... <i>Bore d_2 (mm) from ... to ...</i>	10-25	10-28	11-32	14-42	14-50

Standard-Zahnscheiben für Taper-Buchsen *Timing belt pulleys for taper bushes*

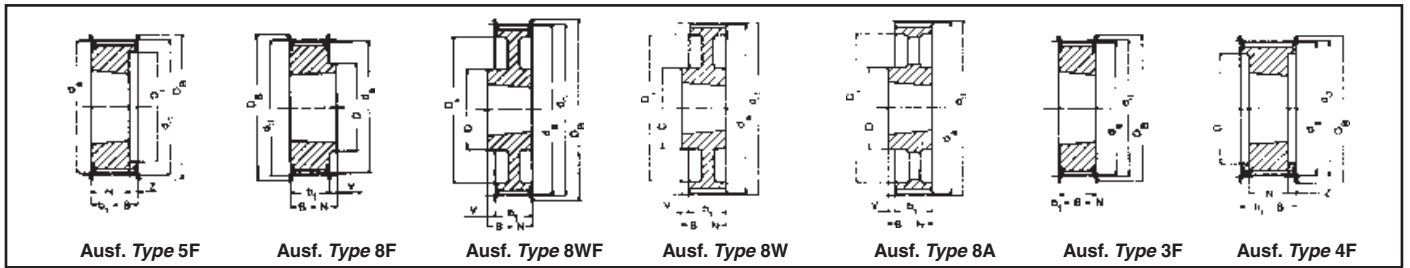

Type 8M – Teilung *Pitch 8 mm für Riemenbreite for belt width 20 mm*

Bezeichnung Part no.	Anzahl der Zähne No. of teeth	Ausführung Type	Material	d_i (mm)	d_a (mm)	D_B (mm)	b_1 (mm)	B (mm)	N (mm)	V (mm)	Z (mm)	D (mm)	D_i (mm)	Taper-Buchse Taper bush	Gewicht ohne Buchse Weight without bush (= kg)
TB 22-8M-20	22	5F	GG	56,02	54,65	60,0	28	28	22	—	6	—	41	1008	0,24
TB 24-8M-20	24	5F	GG	61,12	59,75	66,0	28	28	22	—	6	—	42	1108	0,30
TB 26-8M-20	26	5F	GG	66,21	64,84	71,0	28	28	22	—	6	—	46	1108	0,36
TB 28-8M-20	28	5F	GG	71,30	70,08	75,0	28	28	22	—	6	—	50	1108	0,44
TB 30-8M-20	30	5F	GG	76,39	75,13	83,0	28	28	22	—	6	—	58	1108	0,53
TB 32-8M-20	32	5F	GG	81,49	80,16	87,0	28	28	25	—	3	—	62	1610	0,42
TB 34-8M-20	34	5F	GG	86,58	85,22	91,0	28	28	25	—	3	—	65	1610	0,55
TB 36-8M-20	36	5F	GG	91,67	90,30	98,5	28	28	25	—	3	—	68	1610	0,68
TB 38-8M-20	38	5F	GG	96,77	95,39	103,0	28	28	25	—	3	—	72	1610	0,80
TB 40-8M-20	40	5F	GG	101,86	100,49	106,0	28	28	25	—	3	—	76	1610	1,00
TB 44-8M-20	44	8F	GG	112,05	110,67	119,0	28	32	32	4	—	93	—	2012	1,20
TB 48-8M-20	48	8F	GG	122,23	120,86	127,0	28	32	32	4	—	96	—	2012	1,60
TB 56-8M-20	56	8F	GG	142,60	141,23	148,0	28	32	32	4	—	110	—	2012	2,40
TB 64-8M-20	64	8WF	GG	162,97	161,60	168,0	28	32	32	4	—	110	137	2012	2,70
TB 72-8M-20	72	8WF	GG	183,35	181,97	192,0	28	32	32	4	—	110	158	2012	3,30
TB 80-8M-20	80	8W	GG	203,72	202,35	—	28	32	32	4	—	110	180	2012	3,50
TB 90-8M-20	90	8A	GG	229,18	227,81	—	28	32	32	4	—	110	204	2012	3,65

Type 8M – Teilung *Pitch 8 mm für Riemenbreite for belt width 30 mm*

TB 22-8M-30	22	5F	GG	56,02	54,65	60,0	38	38	22	—	16	—	41	1008	0,29
TB 24-8M-30	24	5F	GG	61,12	59,75	66,0	38	38	22	—	16	—	42	1108	0,38
TB 26-8M-30	26	5F	GG	66,21	64,84	71,0	38	38	22	—	16	—	46	1108	0,45
TB 28-8M-30	28	5F	GG	71,30	70,08	75,0	38	38	25	—	13	—	50	1210	0,50
TB 30-8M-30	30	3F	GG	76,39	75,13	83,0	38	38	38	—	—	—	—	1615	0,45
TB 32-8M-30	32	3F	GG	81,49	80,16	87,0	38	38	38	—	—	—	—	1615	0,59
TB 34-8M-30	34	3F	GG	86,58	85,22	91,0	38	38	38	—	—	—	—	1615	0,77
TB 36-8M-30	36	3F	GG	91,67	90,30	98,5	38	38	38	—	—	—	—	1615	0,96
TB 38-8M-30	38	3F	GG	96,77	95,39	103,0	38	38	38	—	—	—	—	1615	1,15
TB 40-8M-30	40	3F	GG	101,86	100,49	106,0	38	38	38	—	—	—	—	1615	1,34
TB 44-8M-30	44	4F	GG	112,05	110,67	119,0	38	38	32	—	3	—	91	2012	1,33
TB 48-8M-30	48	4F	GG	122,23	120,86	127,0	38	38	32	—	3	—	95	2012	1,78
TB 56-8M-30	56	4F	GG	142,60	141,23	148,0	38	38	32	—	3	—	117	2012	3,76
TB 64-8M-30	64	8F	GG	162,97	161,60	168,0	38	45	45	7	—	125	—	2517	4,20
TB 72-8M-30	72	8WF	GG	183,35	181,97	192,0	38	45	45	7	—	125	158	2517	4,30
TB 80-8M-30	80	8W	GG	203,72	202,35	—	38	45	45	7	—	125	180	2517	4,60
TB 90-8M-30	90	8A	GG	229,18	227,81	—	38	45	45	7	—	125	204	2517	5,00
TB 112-8M-30	112	8A	GG	285,21	283,83	—	38	45	45	7	—	125	260	2517	6,20
TB 144-8M-30	144	8A	GG	366,69	365,32	—	38	45	45	7	—	125	341	2517	9,00

GG = Grauguss Cast iron

Fertigungstechnische Änderungen vorbehalten.
We reserve the right to make technical changes.

Taper-Buchse Taper bush	1008	1108	1210	1610	1615	2012	2517
Bohrung d_2 (mm) von ... bis ... Bore d_2 (mm) from ... to ...	10-25	10-28	11-32	14-42	14-42	14-50	16-60

Bohrungsdurchmesser d_2 siehe Seite 89.
Bore diameters d_2 see page 89.

Standard-Zahnscheiben für Taper-Buchsen *Timing belt pulleys for taper bushes*

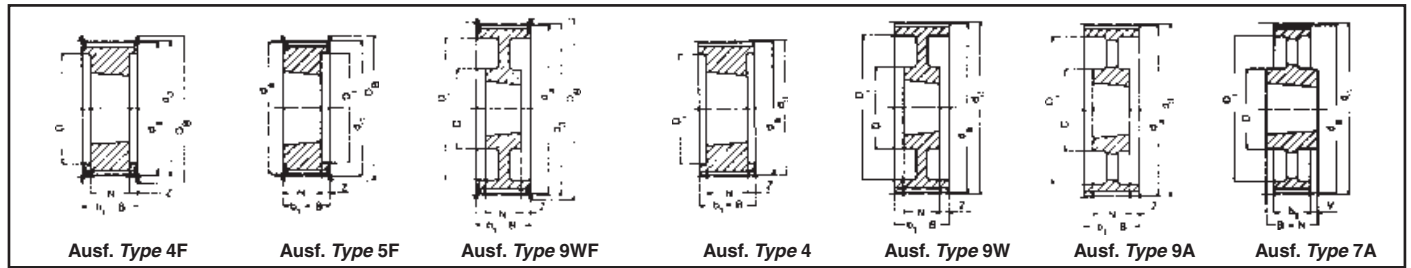

Type 8M – Teilung *Pitch 8 mm für Riemenbreite for belt width 50 mm*

Bezeichnung Part no.	Anzahl der Zähne No. of teeth	Ausführung Type	Material	d_d (mm)	d_a (mm)	D_B (mm)	b_1 (mm)	B (mm)	N (mm)	V (mm)	Z (mm)	D (mm)	D_i (mm)	Taper-Buchse Taper bush	Gewicht ohne Buchse Weight without bush (= kg)
TB 28-8M-50	28	5F	GG	71,30	70,08	75,0	60	60	25	—	35,0	—	50	1210	0,60
TB 30-8M-50	30	5F	GG	76,39	75,13	83,0	60	60	38	—	22,0	—	58	1615	0,65
TB 32-8M-50	32	5F	GG	81,49	80,16	87,0	60	60	38	—	22,0	—	62	1615	0,82
TB 34-8M-50	34	5F	GG	86,58	85,22	91,0	60	60	38	—	22,0	—	65	1615	1,06
TB 36-8M-50	36	5F	GG	91,67	90,30	98,5	60	60	38	—	22,0	—	68	1615	1,30
TB 38-8M-50	38	5F	GG	96,77	95,39	103,0	60	60	38	—	22,0	—	72	1615	1,60
TB 40-8M-50	40	4F	GG	101,86	100,49	106,0	60	60	32	—	14,0	—	82	2012	1,71
TB 44-8M-50	44	4F	GG	112,05	110,67	119,0	60	60	32	—	14,0	—	91	2012	1,78
TB 48-8M-50	48	4F	GG	122,23	120,86	127,0	60	60	32	—	14,0	—	95	2012	2,30
TB 56-8M-50	56	4F	GG	142,60	141,23	148,0	60	60	45	—	7,5	—	116	2517	3,40
TB 64-8M-50	64	4F	GG	162,97	161,60	168,0	60	60	45	—	7,5	—	137	2517	5,00
TB 72-8M-50	72	9WF	GG	183,35	181,97	192,0	60	60	45	—	7,5	125	158	2517	6,70
TB 80-8M-50	80	4	GG	203,72	202,35	—	60	60	51	—	4,5	—	180	3020	8,80
TB 90-8M-50	90	9W	GG	229,18	227,81	—	60	60	51	—	4,5	170	204	3020	10,00
TB 112-8M-50	112	9W	GG	285,21	283,83	—	60	60	51	—	4,5	170	260	3020	12,00
TB 144-8M-50	144	9A	GG	366,69	365,32	—	60	60	51	—	4,5	170	341	3020	15,20
TB 168-8M-50	168	7A	GG	427,81	426,44	—	60	65	65	—	2,5	170	402	3525	16,40
TB 192-8M-50	192	7A	GG	488,92	487,55	—	60	65	65	—	2,5	170	460	3525	21,80

Type 8M – Teilung *Pitch 8 mm für Riemenbreite for belt width 85 mm*

TB 34-8M-85	34	4F	GG	86,58	85,22	91,0	95	95	38	—	28,5	—	65	1615	1,43
TB 36-8M-85	36	4F	GG	91,67	90,30	98,5	95	95	38	—	28,5	—	68	1615	1,87
TB 38-8M-85	38	4F	GG	96,77	95,39	103,0	95	95	38	—	28,5	—	72	1615	2,20
TB 40-8M-85	40	4F	GG	101,86	100,49	106,0	95	95	32	—	31,5	—	82	2012	1,78
TB 44-8M-85	44	4F	GG	112,05	110,67	119,0	95	95	32	—	31,5	—	91	2012	2,30
TB 48-8M-85	48	4F	GG	122,23	120,86	127,0	95	95	45	—	25,0	—	100	2517	2,66
TB 56-8M-85	56	4F	GG	142,60	141,23	148,0	95	95	45	—	25,0	—	117	2517	4,45
TB 64-8M-85	64	4F	GG	162,97	161,60	168,0	95	95	45	—	25,0	—	137	2517	6,20
TB 72-8M-85	72	4F	GG	183,35	181,97	192,0	95	95	51	—	22,0	—	158	3020	8,00
TB 80-8M-85	80	4	GG	203,72	202,35	—	95	95	51	—	22,0	—	180	3020	10,00
TB 90-8M-85	90	9W	GG	229,18	227,81	—	95	95	51	—	22,0	170	204	3020	10,80
TB 112-8M-85	112	9W	GG	285,21	283,83	—	95	95	51	—	22,0	170	260	3020	15,00
TB 144-8M-85	144	9A	GG	366,69	365,32	—	95	95	76	—	15,0	170	341	3525	20,00
TB 168-8M-85	168	9A	GG	427,81	426,44	—	95	95	76	—	15,0	170	402	3525	23,00
TB 192-8M-85	192	9A	GG	488,92	487,55	—	95	95	76	—	15,0	170	460	3525	28,50

GG = Grauguss Cast iron

Fertigungstechnische Änderungen vorbehalten.
We reserve the right to make technical changes.

Taper-Buchse Taper bush	1210	1615	2012	2517	3020	3525
Bohrung d_2 (mm) von ... bis ... Bore d_2 (mm) from ... to ...	11-32	14-42	14-50	16-60	25-75	35-90

Bohrungsdurchmesser d_2 siehe Seite 89.
Bore diameters d_2 see page 89.

Standard-Zahnscheiben für Taper-Buchsen *Timing belt pulleys for taper bushes*

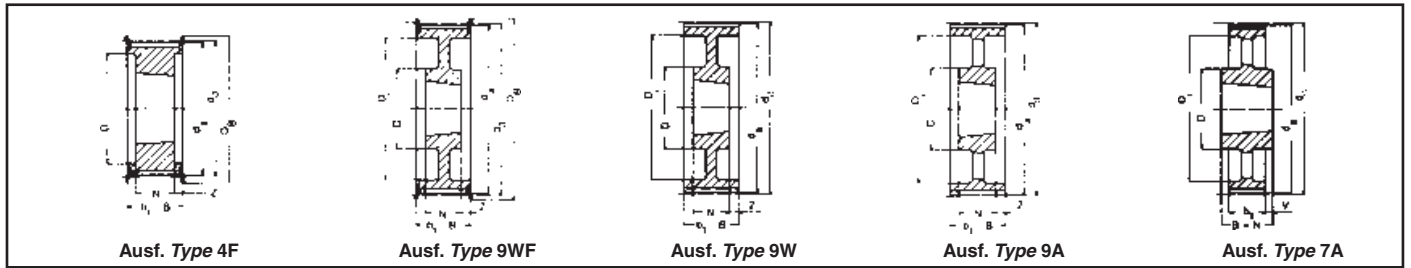

Type 14M – Teilung *Pitch 14 mm* für Riemenbreite *for belt width 40 mm*

Bezeichnung <i>Part no.</i>	Anzahl der Zähne <i>No. of teeth</i>	Ausführung <i>Type</i>	Material	d_d (mm)	d_a (mm)	D_B (mm)	b_1 (mm)	B (mm)	N (mm)	V (mm)	Z (mm)	D (mm)	D_i (mm)	Taper-Buchse <i>Taper bush</i>	Gewicht ohne Buchse <i>Weight without bush</i> (= kg)
TB 28-14M-40	28	4F	GG	124,78	122,12	127	54	54	32	—	11,0	—	98	2012	2,00
TB 29-14M-40	29	4F	GG	129,23	126,57	138	54	54	32	—	11,0	—	100	2012	2,38
TB 30-14M-40	30	4F	GG	133,69	130,99	138	54	54	32	—	11,0	—	100	2012	2,65
TB 32-14M-40	32	4F	GG	142,60	139,88	154	54	54	32	—	11,0	—	104	2012	3,40
TB 34-14M-40	34	4F	GG	151,52	148,79	160	54	54	45	—	4,5	—	110	2517	3,87
TB 36-14M-40	36	4F	GG	160,43	157,68	168	54	54	45	—	4,5	—	120	2517	4,80
TB 38-14M-40	38	4F	GG	169,34	166,60	183	54	54	45	—	4,5	—	130	2517	5,40
TB 40-14M-40	40	4F	GG	178,25	175,49	188	54	54	45	—	4,5	—	138	2517	6,00
TB 44-14M-40	44	4F	GG	196,08	193,28	211	54	54	51	—	1,5	—	155	3020	7,80
TB 48-14M-40	48	4F	GG	213,90	211,11	226	54	54	51	—	1,5	—	170	3020	9,40
TB 56-14M-40	56	9WF	GG	249,55	246,76	256	54	54	51	—	1,5	170	208	3020	10,80
TB 64-14M-40	64	9WF	GG	285,21	282,41	296	54	54	51	—	1,5	170	242	3020	13,40
TB 72-14M-40	72	9W	GG	320,86	318,06	—	54	54	51	—	1,5	170	280	3020	15,20
TB 80-14M-40	80	9A	GG	356,51	353,71	—	54	54	51	—	1,5	170	315	3020	16,00
TB 90-14M-40	90	9A	GG	401,07	398,28	—	54	54	51	—	1,5	170	360	3020	17,80
TB 112-14M-40	112	9A	GG	499,11	496,32	—	54	54	51	—	1,5	170	457	3020	25,60
TB 144-14M-40	144	9A	GG	641,71	638,92	—	54	54	51	—	1,5	170	600	3020	32,00
TB 168-14M-40	168	9A	GG	748,66	745,87	—	54	54	51	—	1,5	170	706	3020	44,00
TB 192-14M-40	192	9A	GG	855,62	852,82	—	54	54	51	—	1,5	170	813	3020	49,00
TB 216-14M-40	216	9A	GG	962,57	959,77	—	54	54	51	—	1,5	170	920	3020	55,00

Type 14M – Teilung *Pitch 14 mm* für Riemenbreite *for belt width 55 mm*

TB 28-14M-55	28	4F	GG	124,78	122,12	127	70	70	32	—	19,0	—	98	2012	2,20
TB 29-14M-55	29	4F	GG	129,23	126,57	138	70	70	32	—	19,0	—	100	2012	2,74
TB 30-14M-55	30	4F	GG	133,69	130,99	138	70	70	45	—	12,5	—	100	2517	2,70
TB 32-14M-55	32	4F	GG	142,60	139,88	154	70	70	45	—	12,5	—	108	2517	3,66
TB 34-14M-55	34	4F	GG	151,52	148,79	160	70	70	45	—	12,5	—	110	2517	4,55
TB 36-14M-55	36	4F	GG	160,43	157,68	168	70	70	45	—	12,5	—	120	2517	5,20
TB 38-14M-55	38	4F	GG	169,34	166,60	183	70	70	45	—	12,5	—	130	2517	6,20
TB 40-14M-55	40	4F	GG	178,25	175,49	188	70	70	45	—	12,5	—	138	2517	7,00
TB 44-14M-55	44	4F	GG	196,08	193,28	211	70	70	51	—	9,5	—	155	3020	8,60
TB 48-14M-55	48	4F	GG	213,90	211,11	226	70	70	51	—	9,5	—	170	3020	10,40
TB 56-14M-55	56	9WF	GG	249,55	246,76	256	70	70	51	—	9,5	170	208	3020	12,00
TB 64-14M-55	64	9WF	GG	285,21	282,41	296	70	70	51	—	9,5	170	242	3020	14,50
TB 72-14M-55	72	9W	GG	320,86	318,06	—	70	70	51	—	9,5	170	280	3020	16,20
TB 80-14M-55	80	9A	GG	356,51	353,71	—	70	70	51	—	9,5	170	315	3020	17,50
TB 90-14M-55	90	9A	GG	401,07	398,28	—	70	70	51	—	9,5	170	360	3020	20,10
TB 112-14M-55	112	9A	GG	499,11	496,32	—	70	70	51	—	9,5	170	457	3020	28,40
TB 144-14M-55	144	9A	GG	641,71	638,92	—	70	70	51	—	9,5	170	600	3020	36,20
TB 168-14M-55	168	9A	GG	748,66	745,87	—	70	70	51	—	9,5	170	706	3020	49,00
TB 192-14M-55	192	9A	GG	855,62	852,82	—	70	70	51	—	9,5	170	813	3020	53,00
TB 216-14M-55	216	7A	GG	962,57	959,77	—	70	89	89	9,5	—	190	920	3535	65,80

GG = Grauguss *Cast iron*

Fertigungstechnische Änderungen vorbehalten.
We reserve the right to make technical changes.

Taper-Buchse <i>Taper bush</i>	2012	2517	3020	3535
Bohrung d_2 (mm) von ... bis ... <i>Bore d_2 (mm) from ... to ...</i>	14-50	16-60	25-75	35-90

Bohrungsdurchmesser d_2 siehe Seite 89.
Bore diameters d_2 see page 89.

Standard-Zahnscheiben für Taper-Buchsen *Timing belt pulleys for taper bushes*

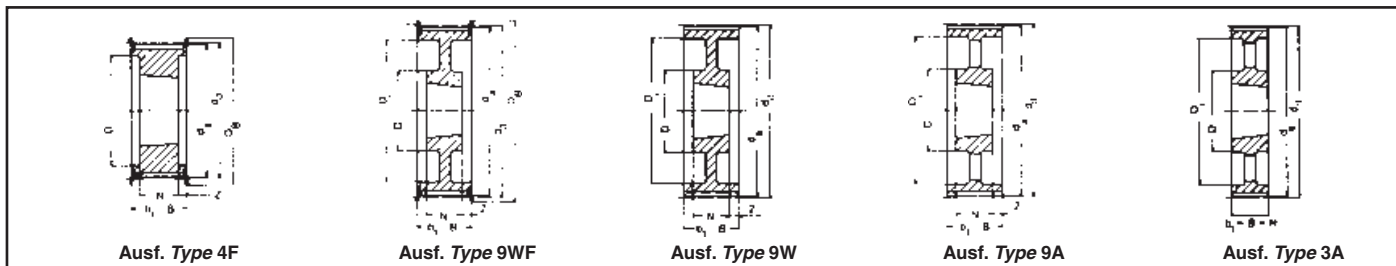

Type 14M – Teilung *Pitch 14 mm* für Riemenbreite *for belt width 85 mm*

Bezeichnung <i>Part no.</i>	Anzahl der Zähne <i>No. of teeth</i>	Ausführung <i>Type</i>	Material	d_d (mm)	d_a (mm)	D_B (mm)	b_1 (mm)	B (mm)	N (mm)	V (mm)	Z (mm)	D (mm)	D_1 (mm)	Taper-Buchse <i>Taper bush</i>	Gewicht ohne Buchse <i>Weight without bush</i> (= kg)
TB 28-14M-85	28	4F	GG	124,78	122,12	127	102	102	45	—	28,5	—	98	2517	2,70
TB 29-14M-85	29	4F	GG	129,23	126,57	138	102	102	45	—	28,5	—	100	2517	3,40
TB 30-14M-85	30	4F	GG	133,69	130,99	138	102	102	45	—	28,5	—	100	2517	3,75
TB 32-14M-85	32	4F	GG	142,60	139,88	154	102	102	45	—	28,5	—	108	2517	4,80
TB 34-14M-85	34	4F	GG	151,52	148,79	160	102	102	45	—	28,5	—	110	2517	6,00
TB 36-14M-85	36	4F	GG	160,43	157,68	168	102	102	51	—	25,5	—	120	3020	5,80
TB 38-14M-85	38	4F	GG	169,34	166,60	183	102	102	51	—	25,5	—	130	3020	6,80
TB 40-14M-85	40	4F	GG	178,25	175,49	188	102	102	51	—	25,5	—	138	3020	8,00
TB 44-14M-85	44	4F	GG	196,08	193,28	211	102	102	76	—	13,0	—	155	3030	11,80
TB 48-14M-85	48	4F	GG	213,90	211,11	226	102	102	76	—	13,0	—	170	3030	15,10
TB 56-14M-85	56	4F	GG	249,55	246,76	256	102	102	65	—	18,5	190	210	3525	19,00
TB 64-14M-85	64	9WF	GG	285,21	282,41	296	102	102	65	—	18,5	190	242	3525	23,00
TB 72-14M-85	72	9W	GG	320,86	318,06	—	102	102	65	—	18,5	190	280	3525	25,00
TB 80-14M-85	80	9A	GG	356,51	353,71	—	102	102	65	—	18,5	190	315	3525	26,00
TB 90-14M-85	90	9A	GG	401,07	398,28	—	102	102	65	—	18,5	190	360	3525	27,80
TB 112-14M-85	112	9A	GG	499,11	496,32	—	102	102	65	—	18,5	190	457	3525	36,50
TB 144-14M-85	144	9A	GG	641,71	638,92	—	102	102	65	—	18,5	190	600	3525	48,00
TB 168-14M-85	168	9A	GG	748,66	745,87	—	102	102	65	—	18,5	190	706	3525	60,00
TB 192-14M-85	192	3A	GG	855,62	852,82	—	102	102	102	—	—	230	813	4040	86,00
TB 216-14M-85	216	3A	GG	962,57	959,77	—	102	102	102	—	—	230	920	4040	91,50

Type 14M – Teilung *Pitch 14 mm* für Riemenbreite *for belt width 115 mm*

TB 28-14M-115	28	4F	GG	124,78	122,12	127	133	133	45	—	44,0	—	98	2517	3,77
TB 29-14M-115	29	4F	GG	129,23	126,57	138	133	133	45	—	44,0	—	100	2517	4,00
TB 30-14M-115	30	4F	GG	133,69	130,99	138	133	133	45	—	44,0	—	100	2517	5,00
TB 32-14M-115	32	4F	GG	142,60	139,88	154	133	133	45	—	44,0	—	108	2517	6,80
TB 34-14M-115	34	4F	GG	151,52	148,79	160	133	133	45	—	44,0	—	110	2517	6,80
TB 36-14M-115	36	4F	GG	160,43	157,68	168	133	133	51	—	41,0	—	120	3020	7,00
TB 38-14M-115	38	4F	GG	169,34	166,60	183	133	133	51	—	41,0	—	130	3020	8,40
TB 40-14M-115	40	4F	GG	178,25	175,49	188	133	133	51	—	41,0	—	140	3020	9,20
TB 44-14M-115	44	4F	GG	196,08	193,28	211	133	133	76	—	28,5	—	155	3030	14,00
TB 48-14M-115	48	4F	GG	213,90	211,11	226	133	133	76	—	28,5	—	170	3030	17,10
TB 56-14M-115	56	4F	GG	249,55	246,76	256	133	133	89	—	22,0	—	210	3535	24,80
TB 64-14M-115	64	9WF	GG	285,21	282,41	296	133	133	89	—	22,0	190	242	3535	27,00
TB 72-14M-115	72	9W	GG	320,86	318,06	—	133	133	89	—	22,0	190	280	3535	29,00
TB 80-14M-115	80	9A	GG	356,51	353,71	—	133	133	89	—	22,0	190	315	3535	32,00
TB 90-14M-115	90	9A	GG	401,07	398,28	—	133	133	89	—	22,0	190	360	3535	36,50
TB 112-14M-115	112	9A	GG	499,11	496,32	—	133	133	89	—	22,0	190	457	3535	46,00
TB 144-14M-115	144	9A	GG	641,71	638,92	—	133	133	102	—	15,5	230	600	4040	68,00
TB 168-14M-115	168	9A	GG	748,66	745,87	—	133	133	102	—	15,5	230	706	4040	82,60
TB 192-14M-115	192	9A	GG	855,62	852,82	—	133	133	102	—	15,5	230	813	4040	96,00
TB 216-14M-115	216	9A	GG	962,57	959,77	—	133	133	102	—	15,5	230	920	4040	107,00

GG = Grauguss Cast iron

Fertigungstechnische Änderungen vorbehalten.
We reserve the right to make technical changes.

Taper-Buchse <i>Taper bush</i>	2517	3020	3030	3525	3535	4040
Bohrung d_2 (mm) von ... bis ... <i>Bore d_2 (mm) from ... to ...</i>	16-60	25-75	35-75	35-90	35-90	40-100

Bohrungsdurchmesser d_2 siehe Seite 89.
Bore diameters d_2 see page 89.

Standard-Zahnscheiben für Taper-Buchsen *Timing belt pulleys for taper bushes*

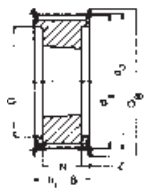

Ausf. Type 4F

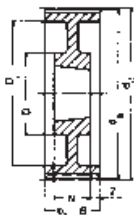

Ausf. Type 9W

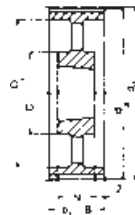

Ausf. Type 9A

Type 14M – Teilung *Pitch 14 mm für Riemenbreite for belt width 170 mm*

Bezeichnung <i>Part no.</i>	Anzahl der Zähne <i>No. of teeth</i>	Ausführung <i>Type</i>	Material	d_d (mm)	d_a (mm)	D_B (mm)	b_1 (mm)	B (mm)	N (mm)	V (mm)	Z (mm)	D (mm)	D_i (mm)	Taper-Buchse <i>Taper bush</i>	Gewicht ohne Buchse <i>Weight without bush</i> (= kg)
TB 38-14M-170*	38	4F	GG	169,34	166,60	183	187	187	76	—	55,5	—	130	3030	11,70
TB 40-14M-170*	40	4F	GG	178,25	175,49	188	187	187	76	—	55,5	—	140	3030	13,00
TB 44-14M-170*	44	4F	GG	196,08	193,28	211	187	187	89	—	49,0	—	155	3535	15,00
TB 48-14M-170*	48	4F	GG	213,90	211,11	226	187	187	89	—	49,0	—	175	3535	19,00
TB 56-14M-170*	56	4F	GG	249,55	246,76	256	187	187	89	—	49,0	—	210	3535	28,50
TB 64-14M-170*	64	4F	GG	285,21	282,41	296	187	187	102	—	42,5	—	240	4040	41,00
TB 72-14M-170*	72	9W	GG	320,86	318,06	—	187	187	102	—	42,5	230	280	4040	46,90
TB 80-14M-170*	80	9W	GG	356,51	353,71	—	187	187	102	—	42,5	230	315	4040	48,00
TB 90-14M-170*	90	9A	GG	401,07	398,28	—	187	187	102	—	42,5	230	360	4040	52,50
TB 112-14M-170*	112	9A	GG	499,11	496,32	—	187	187	127	—	30,0	265	457	5050	74,50
TB 144-14M-170*	144	9A	GG	641,71	638,92	—	187	187	127	—	30,0	265	600	5050	91,00
TB 168-14M-170*	168	9A	GG	748,66	745,87	—	187	187	127	—	30,0	265	706	5050	116,00
TB 192-14M-170*	192	9A	GG	855,62	852,82	—	187	187	127	—	30,0	265	813	5050	134,00
TB 216-14M-170*	216	9A	GG	962,57	959,77	—	187	187	127	—	30,0	265	920	5050	146,50

HTD®-Zahnscheiben Type 20M auf Anfrage *HTD® Pulleys type 20M on request*

GG = Grauguss *Cast iron*

Fertigungstechnische Änderungen vorbehalten.
We reserve the right to make technical changes.

* **Keine Lagerware *Non stock items***

Bohrungsdurchmesser d_2 siehe Seite 89.
Bore diameters d_2 see page 89.

Taper-Buchse <i>Taper bush</i>	3030	3535	4040	5050
Bohrung d_2 (mm) von ... bis ... <i>Bore d_2 (mm) from ... to ...</i>	35-75	35-90	40-100	70-125

Metrische Zahnscheiben für zylindrische Bohrung *Metric timing belt pulleys for plain boring*

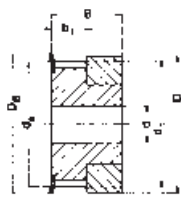

Ausf. Type 1F

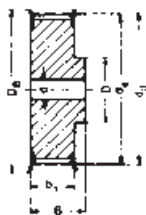

Ausf. Type 6F



Ausf. Type 6

Type T 2,5 – Teilung *Pitch 2,5 mm für Riemenbreite for belt width 4 und and 6 mm*

Bezeichnung Part no.	Anzahl der Zähne No. of teeth	Aus- führung Type	Material	d_d (mm)	d_a (mm)	D_B (mm)	b_1 (mm)	B (mm)	D (mm)	D_i (mm)	Vor- bohrung Pilot bore d (mm)	Fertig- bohrung Finished bore d_{max} (mm)	Gewicht Weight (≈ kg)
16 T2,5/12-2	12	1F	Al	9,55	9,00	13,0	9	16	12	—	—	3	0,003
16 T2,5/14-2	14	1F	Al	11,14	10,60	15,0	9	16	14	—	—	4	0,004
16 T2,5/15-2	15	1F	Al	11,94	11,40	15,0	9	16	15	—	—	4	0,005
16 T2,5/16-2	16	1F	Al	12,73	12,20	16,0	9	16	16	—	—	5	0,005
16 T2,5/18-2	18	6F	Al	14,32	13,80	17,5	10	16	9,5	—	4	6	0,006
16 T2,5/19-2	19	6F	Al	15,12	14,60	18,0	10	16	9,5	—	4	6	0,007
16 T2,5/20-2	20	6F	Al	15,92	15,40	19,5	10	16	10	—	4	6	0,008
16 T2,5/22-2	22	6F	Al	17,51	17,00	23,0	10	16	10	—	4	6	0,009
16 T2,5/24-2	24	6F	Al	19,10	18,55	23,0	10	16	12	—	4	6	0,012
16 T2,5/25-2	25	6F	Al	19,90	19,35	23,0	10	16	12	—	4	8	0,013
16 T2,5/26-2	26	6F	Al	20,70	20,15	25,0	10	16	13	—	4	8	0,014
16 T2,5/28-2	28	6F	Al	22,28	21,75	25,0	10	16	13	—	4	8	0,016
16 T2,5/30-2	30	6F	Al	23,87	23,35	28,0	10	16	16	—	6	10	0,018
16 T2,5/32-2	32	6F	Al	25,47	24,95	32,0	10	16	16	—	6	10	0,020
16 T2,5/36-2	36	6F	Al	28,65	28,10	36,0	10	16	20	—	6	12	0,026
16 T2,5/40-2	40	6F	Al	31,83	31,30	38,0	10	16	20	—	6	12	0,032
16 T2,5/44-2	44	6F	Al	35,02	34,50	42,0	10	16	24	—	6	14	0,040
16 T2,5/48-0	48	6	Al	38,20	37,70	—	10	16	26	—	6	15	0,048
16 T2,5/60-0	60	6	Al	47,75	47,25	—	10	16	34	—	8	18	0,073

Metrische Zahnscheiben für zylindrische Bohrung *Metric timing belt pulleys for plain boring*

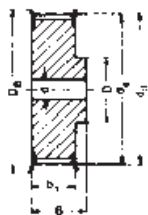

Ausf. Type 6F



Ausf. Type 6

Type T 5 – Teilung *Pitch 5 mm* für Riemenbreite *for belt width 10 mm*

Bezeichnung Part no.	Anzahl der Zähne No. of teeth	Aus- führung Type	Material	d _g (mm)	d _a (mm)	D _B (mm)	b ₁ (mm)	B (mm)	D (mm)	D _i (mm)	Vor- bohrung Pilot bore d (mm)	Fertig- bohrung Finished bore d _{max} (mm)	Gewicht Weight (≈ kg)
21 T5/10-2	10	6F	Al	15,92	15,05	19,5	15	21	8	—	—	5	0,012
21 T5/12-2	12	6F	Al	19,01	18,25	23,0	15	21	10	—	—	6	0,016
21 T5/14-2	14	6F	Al	22,29	21,45	25,0	15	21	13	—	—	8	0,019
21 T5/15-2	15	6F	Al	23,88	23,05	28,0	15	21	16	—	6	10	0,021
21 T5/16-2	16	6F	Al	25,47	24,60	32,0	15	21	18	—	6	11	0,025
21 T5/18-2	18	6F	Al	28,65	27,80	32,0	15	21	19	—	6	12	0,031
21 T5/19-2	19	6F	Al	30,25	29,40	36,0	15	21	22	—	6	12	0,036
21 T5/20-2	20	6F	Al	31,83	31,00	36,0	15	21	23	—	6	14	0,038
21 T5/22-2	22	6F	Al	35,12	34,25	38,0	15	21	24	—	6	15	0,046
21 T5/24-2	24	6F	Al	38,21	37,40	42,0	15	21	26	—	6	15	0,054
21 T5/25-2	25	6F	Al	39,80	39,00	44,0	15	21	26	—	6	15	0,058
21 T5/26-2	26	6F	Al	41,47	40,60	44,0	15	21	26	—	6	16	0,062
21 T5/27-2	27	6F	Al	42,98	42,20	48,0	15	21	30	—	8	18	0,064
21 T5/28-2	28	6F	Al	44,62	43,75	48,0	15	21	32	—	8	18	0,071
21 T5/30-2	30	6F	Al	47,76	46,95	51,0	15	21	34	—	8	18	0,075
21 T5/32-2	32	6F	Al	50,94	50,10	54,0	15	21	38	—	8	22	0,088
21 T5/36-2	36	6F	Al	57,31	56,45	63,0	15	21	38	—	8	22	0,114
21 T5/40-2	40	6F	Al	63,66	62,85	66,0	15	21	40	—	8	23	0,138
21 T5/42-2	42	6F	Al	66,87	66,00	71,0	15	21	40	—	8	24	0,180
21 T5/44-0	44	6	Al	70,07	69,20	—	15	21	45	—	8	26	0,185
21 T5/48-0	48	6	Al	76,42	75,55	—	15	21	50	—	8	28	0,200
21 T5/60-0	60	6	Al	95,52	94,65	—	15	21	65	—	8	35	0,307

Type T 5 – Teilung *Pitch 5 mm* für Riemenbreite *for belt width 16 mm*

27 T5/10-2	10	6F	Al	15,92	15,05	19,5	21	27	8	—	—	5	0,016
27 T5/12-2	12	6F	Al	19,01	18,25	23,0	21	27	10	—	—	6	0,022
27 T5/14-2	14	6F	Al	22,29	21,45	25,0	21	27	13	—	—	8	0,026
27 T5/15-2	15	6F	Al	23,88	23,05	28,0	21	27	16	—	6	10	0,029
27 T5/16-2	16	6F	Al	25,47	24,60	32,0	21	27	18	—	6	11	0,035
27 T5/18-2	18	6F	Al	28,65	27,80	32,0	21	27	19	—	6	12	0,043
27 T5/19-2	19	6F	Al	30,25	29,40	36,0	21	27	22	—	6	12	0,049
27 T5/20-2	20	6F	Al	31,83	31,00	36,0	21	27	23	—	6	14	0,053
27 T5/22-2	22	6F	Al	35,12	34,25	38,0	21	27	24	—	6	15	0,054
27 T5/24-2	24	6F	Al	38,21	37,40	42,0	21	27	26	—	6	15	0,076
27 T5/25-2	25	6F	Al	39,80	39,00	44,0	21	27	26	—	6	15	0,081
27 T5/26-2	26	6F	Al	41,47	40,60	44,0	21	27	26	—	6	16	0,085
27 T5/27-2	27	6F	Al	42,98	42,20	48,0	21	27	30	—	8	18	0,090
27 T5/28-2	28	6F	Al	44,62	43,75	48,0	21	27	32	—	8	18	0,092
27 T5/30-2	30	6F	Al	47,76	46,95	51,0	21	27	34	—	8	18	0,105
27 T5/32-2	32	6F	Al	50,94	50,10	54,0	21	27	38	—	8	22	0,123
27 T5/36-2	36	6F	Al	57,31	56,45	63,0	21	27	38	—	8	22	0,160
27 T5/40-2	40	6F	Al	63,66	62,85	66,0	21	27	40	—	8	23	0,193
27 T5/42-2	42	6F	Al	66,87	66,00	71,0	21	27	40	—	8	24	0,205
27 T5/44-0	44	6	Al	70,07	69,20	—	21	27	45	—	8	26	0,228
27 T5/48-0	48	6	Al	76,42	75,55	—	21	27	50	—	8	28	0,280
27 T5/60-0	60	6	Al	95,52	94,65	—	21	27	65	—	8	35	0,430

Metrische Zahnscheiben für zylindrische Bohrung *Metric timing belt pulleys for plain boring*

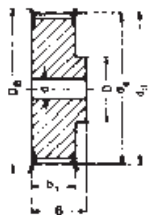

Ausf. Type 6F



Ausf. Type 6

Type T 5 – Teilung *Pitch 5 mm* für Riemenbreite *for belt width 25 mm*

Bezeichnung Part no.	Anzahl der Zähne No. of teeth	Aus- führung Type	Material	d _g (mm)	d _a (mm)	D _B (mm)	b ₁ (mm)	B (mm)	D (mm)	D _i (mm)	Vor- bohrung Pilot bore d (mm)	Fertig- bohrung Finished bore d _{max} (mm)	Gewicht Weight (≈ kg)
36 T5/10-2	10	6F	Al	15,92	15,05	19,5	30	36	8	—	—	5	0,023
36 T5/12-2	12	6F	Al	19,01	18,25	23,0	30	36	10	—	—	6	0,031
36 T5/14-2	14	6F	Al	22,29	21,45	25,0	30	36	13	—	—	8	0,037
36 T5/15-2	15	6F	Al	23,88	23,05	28,0	30	36	16	—	6	10	0,041
36 T5/16-2	16	6F	Al	25,47	24,60	32,0	30	36	18	—	6	11	0,050
36 T5/18-2	18	6F	Al	28,65	27,80	32,0	30	36	19	—	6	12	0,061
36 T5/19-2	19	6F	Al	30,25	29,40	36,0	30	36	22	—	6	12	0,070
36 T5/20-2	20	6F	Al	31,83	31,00	36,0	30	36	23	—	6	14	0,076
36 T5/22-2	22	6F	Al	35,12	34,25	38,0	30	36	24	—	6	15	0,080
36 T5/24-2	24	6F	Al	38,21	37,40	42,0	30	36	26	—	8	15	0,109
36 T5/25-2	25	6F	Al	39,80	39,00	44,0	30	36	26	—	8	15	0,116
36 T5/26-2	26	6F	Al	41,47	40,60	44,0	30	36	26	—	8	16	0,120
36 T5/27-2	27	6F	Al	42,98	42,20	48,0	30	36	30	—	8	18	0,128
36 T5/28-2	28	6F	Al	44,62	43,75	48,0	30	36	32	—	8	18	0,135
36 T5/30-2	30	6F	Al	47,76	46,95	51,0	30	36	34	—	8	18	0,150
36 T5/32-2	32	6F	Al	50,94	50,10	54,0	30	36	38	—	8	22	0,176
36 T5/36-2	36	6F	Al	57,31	56,45	63,0	30	36	38	—	8	22	0,230
36 T5/40-2	40	6F	Al	63,66	62,85	66,0	30	36	40	—	8	23	0,276
36 T5/42-2	42	6F	Al	66,87	66,00	71,0	30	36	40	—	8	24	0,284
36 T5/44-0	44	6	Al	70,07	69,20	—	30	36	45	—	8	26	0,315
36 T5/48-0	48	6	Al	76,42	75,55	—	30	36	50	—	8	28	0,400
36 T5/60-0	60	6	Al	95,52	94,65	—	30	36	65	—	8	35	0,614

Metrische Zahnscheiben für zylindrische Bohrung *Metric timing belt pulleys for plain boring*

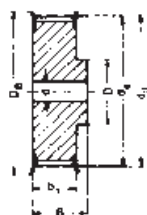

Ausf. Type 6F



Ausf. Type 6

Type T 10 – Teilung *Pitch 10 mm* für Riemenbreite *for belt width 16 mm*

Bezeichnung Part no.	Anzahl der Zähne No. of teeth	Aus- führung Type	Material	d _g (mm)	d _a (mm)	D _B (mm)	b ₁ (mm)	B (mm)	D (mm)	D _i (mm)	Vor- bohrung Pilot bore d (mm)	Fertig- bohrung Finished bore d _{max} (mm)	Gewicht Weight (≈ kg)
31 T10/12-2	12	6F	Al	38,20	36,35	42	21	31	28	—	6	16	0,076
31 T10/14-2	14	6F	Al	44,56	42,70	48	21	31	32	—	8	18	0,104
31 T10/15-2	15	6F	Al	47,75	45,90	51	21	31	32	—	8	18	0,116
31 T10/16-2	16	6F	Al	50,93	49,05	54	21	31	35	—	8	20	0,134
31 T10/18-2	18	6F	Al	57,29	55,45	60	21	31	40	—	8	22	0,167
31 T10/19-2	19	6F	Al	60,48	58,60	66	21	31	44	—	8	22	0,184
31 T10/20-2	20	6F	Al	63,66	61,80	66	21	31	46	—	8	24	0,208
31 T10/22-2	22	6F	Al	70,03	68,15	75	21	31	52	—	8	28	0,253
31 T10/24-2	24	6F	Al	76,39	74,55	83	21	31	58	—	8	30	0,288
31 T10/25-2	25	6F	Al	79,58	77,70	83	21	31	60	—	8	30	0,310
31 T10/26-2	26	6F	Al	82,76	80,90	87	21	31	60	—	8	30	0,357
31 T10/27-2	27	6F	Al	85,95	84,10	91	21	31	60	—	8	30	0,364
31 T10/28-2	28	6F	Al	89,13	87,25	93	21	31	60	—	8	30	0,401
31 T10/30-2	30	6F	Al	95,49	93,65	97	21	31	60	—	8	30	0,441
31 T10/32-2	32	6F	Al	101,86	100,00	106	21	31	65	—	10	32	0,493
31 T10/36-2	36	6F	Al	114,59	112,75	119	21	31	70	—	10	35	0,623
31 T10/40-2	40	6F	Al	127,32	125,45	131	21	31	80	—	10	40	0,767
31 T10/44-0	44	6	Al	140,06	138,20	—	21	31	88	—	10	46	0,993
31 T10/48-0	48	6	Al	152,78	150,95	—	21	31	95	—	16	48	1,090
31 T10/60-0	60	6	Al	190,98	189,10	—	21	31	110	—	16	60	1,710

Type T 10 – Teilung *Pitch 10 mm* für Riemenbreite *for belt width 25 mm*

40 T10/12-2	12	6F	Al	38,20	36,35	42	30	40	28	—	6	16	0,099
40 T10/14-2	14	6F	Al	44,56	42,70	48	30	40	32	—	8	18	0,134
40 T10/15-2	15	6F	Al	47,75	45,90	51	30	40	32	—	8	18	0,152
40 T10/16-2	16	6F	Al	50,93	49,05	54	30	40	35	—	8	20	0,176
40 T10/18-2	18	6F	Al	57,29	55,45	60	30	40	40	—	8	22	0,224
40 T10/19-2	19	6F	Al	60,48	58,60	66	30	40	44	—	8	22	0,247
40 T10/20-2	20	6F	Al	63,66	61,80	66	30	40	46	—	8	24	0,276
40 T10/22-2	22	6F	Al	70,03	68,15	75	30	40	52	—	8	28	0,337
40 T10/24-2	24	6F	Al	76,39	74,55	83	30	40	58	—	8	30	0,392
40 T10/25-2	25	6F	Al	79,58	77,70	83	30	40	60	—	8	30	0,422
40 T10/26-2	26	6F	Al	82,76	80,90	87	30	40	60	—	8	30	0,477
40 T10/27-2	27	6F	Al	85,95	84,10	91	30	40	60	—	8	30	0,536
40 T10/28-2	28	6F	Al	89,13	87,25	93	30	40	60	—	8	30	0,540
40 T10/30-2	30	6F	Al	95,49	93,65	97	30	40	60	—	8	30	0,640
40 T10/32-2	32	6F	Al	101,86	100,00	106	30	40	65	—	10	32	0,693
40 T10/36-2	36	6F	Al	114,59	112,75	119	30	40	70	—	10	35	0,873
40 T10/40-2	40	6F	Al	127,32	125,45	131	30	40	80	—	10	40	1,067
40 T10/44-0	44	6	Al	140,06	138,20	—	30	40	88	—	10	46	1,350
40 T10/48-0	48	6	Al	152,78	150,95	—	30	40	95	—	16	48	1,516
40 T10/60-0	60	6	Al	190,98	189,10	—	30	40	110	—	16	60	2,339

Metrische Zahnscheiben für zylindrische Bohrung Metric timing belt pulleys for plain boring

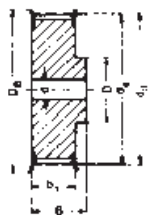

Ausf. Type 6F



Ausf. Type 6

Type T 10 – Teilung Pitch 10 mm für Riemenbreite for belt width 32 mm

Bezeichnung Part no.	Anzahl der Zähne No. of teeth	Aus- führung Type	Material	d _g (mm)	d _a (mm)	D _B (mm)	b ₁ (mm)	B (mm)	D (mm)	D _i (mm)	Vor- bohrung Pilot bore d (mm)	Fertig- bohrung Finished bore d _{max} (mm)	Gewicht Weight (≈ kg)
47 T10/18-2	18	6F	Al	57,29	55,45	60	37	47	40	—	10	22	0,253
47 T10/19-2	19	6F	Al	60,48	58,60	66	37	47	44	—	10	22	0,286
47 T10/20-2	20	6F	Al	63,66	61,80	66	37	47	46	—	12	24	0,322
47 T10/22-2	22	6F	Al	70,03	68,15	75	37	47	52	—	12	28	0,393
47 T10/24-2	24	6F	Al	76,39	74,55	83	37	47	58	—	12	30	0,475
47 T10/25-2	25	6F	Al	79,58	77,70	83	37	47	60	—	12	30	0,527
47 T10/26-2	26	6F	Al	82,76	80,90	87	37	47	60	—	12	30	0,564
47 T10/27-2	27	6F	Al	85,95	84,10	91	37	47	60	—	12	30	0,602
47 T10/28-2	28	6F	Al	89,13	87,25	93	37	47	60	—	12	30	0,642
47 T10/30-2	30	6F	Al	95,49	93,65	97	37	47	60	—	12	30	0,740
47 T10/32-2	32	6F	Al	101,86	100,00	106	37	47	65	—	12	32	0,844
47 T10/36-2	36	6F	Al	114,59	112,75	119	37	47	70	—	16	35	1,083
47 T10/40-2	40	6F	Al	127,32	125,45	131	37	47	80	—	16	40	1,317
47 T10/44-0	44	6	Al	140,06	138,20	—	37	47	88	—	16	46	1,611
47 T10/48-0	48	6	Al	152,78	150,95	—	37	47	95	—	16	48	1,931
47 T10/60-0	60	6	Al	190,98	189,10	—	37	47	110	—	16	60	3,004

Type T 10 – Teilung Pitch 10 mm für Riemenbreite for belt width 50 mm

66 T10/18-2	18	6F	Al	57,29	55,45	60	56	66	40	—	10	22	0,422
66 T10/19-2	19	6F	Al	60,48	58,60	66	56	66	44	—	10	22	0,466
66 T10/20-2	20	6F	Al	63,66	61,80	66	56	66	46	—	12	24	0,520
66 T10/22-2	22	6F	Al	70,03	68,15	75	56	66	52	—	12	28	0,570
66 T10/24-2	24	6F	Al	76,39	74,55	83	56	66	58	—	12	30	0,736
66 T10/25-2	25	6F	Al	79,58	77,70	83	56	66	60	—	12	30	0,766
66 T10/26-2	26	6F	Al	82,76	80,90	87	56	66	60	—	12	30	0,816
66 T10/27-2	27	6F	Al	85,95	84,10	91	56	66	60	—	12	30	0,946
66 T10/28-2	28	6F	Al	89,13	87,25	93	56	66	60	—	12	30	0,960
66 T10/30-2	30	6F	Al	95,49	93,65	97	56	66	60	—	12	30	1,169
66 T10/32-2	32	6F	Al	101,86	100,00	106	56	66	65	—	12	32	1,300
66 T10/36-2	36	6F	Al	114,59	112,75	119	56	66	70	—	16	35	1,637
66 T10/40-2	40	6F	Al	127,32	125,45	131	56	66	80	—	16	40	1,999
66 T10/44-0	44	6	Al	140,06	138,20	—	56	66	88	—	16	46	2,357
66 T10/48-0	48	6	Al	152,78	150,95	—	56	66	95	—	16	48	2,830
66 T10/60-0	60	6	Al	190,98	189,10	—	56	66	110	—	16	60	4,366

Metrische Zahnscheiben für zylindrische Bohrung *Metric timing belt pulleys for plain boring*

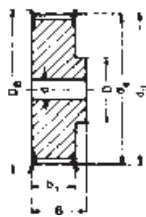

Ausf. Type 6F



Ausf. Type 6

Type AT 5 – Teilung *Pitch 5 mm* für Riemenbreite *for belt width 10 mm*

Bezeichnung <i>Part no.</i>	Anzahl der Zähne <i>No. of teeth</i>	Aus- führung <i>Type</i>	Material	d_d (mm)	d_a (mm)	D_B (mm)	b_1 (mm)	B (mm)	D (mm)	Vor- bohrung <i>Pilot bore d</i> (mm)	Fertig- bohrung <i>Finished bore d_{max}</i> (mm)	Gewicht <i>Weight</i> (= kg)
21 AT 5/12-2	12	6F	Al	19,01	17,85	23,0	15	21	10	—	6	0,016
21 AT 5/14-2	14	6F	Al	22,29	21,05	25,0	15	21	13	—	8	0,019
21 AT 5/15-2	15	6F	Al	23,88	22,65	28,0	15	21	16	6	10	0,021
21 AT 5/16-2	16	6F	Al	25,47	24,20	32,0	15	21	18	6	11	0,025
21 AT 5/18-2	18	6F	Al	28,65	27,40	32,0	15	21	19	6	12	0,031
21 AT 5/19-2	19	6F	Al	30,25	29,00	36,0	15	21	22	6	12	0,036
21 AT 5/20-2	20	6F	Al	31,83	30,60	36,0	15	21	23	6	14	0,038
21 AT 5/22-2	22	6F	Al	35,12	33,85	38,0	15	21	24	6	15	0,046
21 AT 5/24-2	24	6F	Al	38,21	37,00	42,0	15	21	26	6	15	0,054
21 AT 5/25-2	25	6F	Al	39,80	38,60	44,0	15	21	26	6	15	0,058
21 AT 5/26-2	26	6F	Al	41,47	40,20	44,0	15	21	26	6	16	0,062
21 AT 5/27-2	27	6F	Al	42,98	41,80	48,0	15	21	30	8	18	0,064
21 AT 5/28-2	28	6F	Al	44,62	43,35	48,0	15	21	32	8	18	0,071
21 AT 5/30-2	30	6F	Al	47,76	46,55	51,0	15	21	34	8	18	0,075
21 AT 5/32-2	32	6F	Al	50,94	49,70	54,0	15	21	38	8	22	0,088
21 AT 5/36-2	36	6F	Al	57,31	56,05	63,0	15	21	38	8	22	0,114
21 AT 5/40-2	40	6F	Al	63,66	62,45	66,0	15	21	40	8	23	0,138
21 AT 5/42-2	42	6F	Al	66,87	65,60	71,0	15	21	40	8	24	0,180
21 AT 5/44-0	44	6	Al	70,07	68,80	—	15	21	45	8	26	0,185
21 AT 5/48-0	48	6	Al	76,42	75,15	—	15	21	50	8	28	0,200
21 AT 5/60-0	60	6	Al	95,52	94,25	—	15	21	65	8	35	0,307

Type AT 5 – Teilung *Pitch 5 mm* für Riemenbreite *for belt width 16 mm*

27 AT 5/12-2	12	6F	Al	19,01	17,85	23,0	21	27	10	—	6	0,022
27 AT 5/14-2	14	6F	Al	22,29	21,05	25,0	21	27	13	—	8	0,026
27 AT 5/15-2	15	6F	Al	23,88	22,65	28,0	21	27	16	6	10	0,029
27 AT 5/16-2	16	6F	Al	25,47	24,20	32,0	21	27	18	6	11	0,035
27 AT 5/18-2	18	6F	Al	28,65	27,40	32,0	21	27	19	6	12	0,043
27 AT 5/19-2	19	6F	Al	30,25	29,00	36,0	21	27	22	6	12	0,049
27 AT 5/20-2	20	6F	Al	31,83	30,60	36,0	21	27	23	6	14	0,053
27 AT 5/22-2	22	6F	Al	35,12	33,85	38,0	21	27	24	6	15	0,054
27 AT 5/24-2	24	6F	Al	38,21	37,00	42,0	21	27	26	6	15	0,076
27 AT 5/25-2	25	6F	Al	39,80	38,60	44,0	21	27	26	6	15	0,081
27 AT 5/26-2	26	6F	Al	41,47	40,20	44,0	21	27	26	6	16	0,085
27 AT 5/27-2	27	6F	Al	42,98	41,80	48,0	21	27	30	8	18	0,090
27 AT 5/28-2	28	6F	Al	44,62	43,35	48,0	21	27	32	8	18	0,092
27 AT 5/30-2	30	6F	Al	47,76	46,55	51,0	21	27	34	8	18	0,105
27 AT 5/32-2	32	6F	Al	50,94	49,70	54,0	21	27	38	8	22	0,123
27 AT 5/36-2	36	6F	Al	57,31	56,05	63,0	21	27	38	8	22	0,160
27 AT 5/40-2	40	6F	Al	63,66	62,45	66,0	21	27	40	8	23	0,193
27 AT 5/42-2	42	6F	Al	66,87	65,60	71,0	21	27	40	8	24	0,205
27 AT 5/44-0	44	6	Al	70,07	68,80	—	21	27	45	8	26	0,228
27 AT 5/48-0	48	6	Al	76,42	75,15	—	21	27	50	8	28	0,280
27 AT 5/60-0	60	6	Al	95,52	94,25	—	21	27	65	8	35	0,430

Metrische Zahnscheiben für zylindrische Bohrung *Metric timing belt pulleys for plain boring*

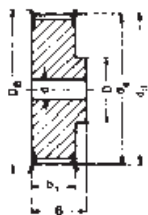

Ausf. Type 6F



Ausf. Type 6

Type AT 5 – Teilung *Pitch 5 mm* für Riemenbreite *for belt width 25 mm*

Bezeichnung <i>Part no.</i>	Anzahl der Zähne <i>No. of teeth</i>	Aus- führung Type	Material	d_d (mm)	d_a (mm)	D_B (mm)	b_1 (mm)	B (mm)	D (mm)	Vor- bohrung <i>Pilot bore d</i> (mm)	Fertig- bohrung <i>Finished bore d_{max}</i> (mm)	Gewicht <i>Weight</i> (= kg)
36 AT 5/12-2	12	6F	Al	19,01	17,85	23,0	30	36	10	—	6	0,031
36 AT 5/14-2	14	6F	Al	22,29	21,05	25,0	30	36	13	—	8	0,037
36 AT 5/15-2	15	6F	Al	23,88	22,65	28,0	30	36	16	6	10	0,041
36 AT 5/16-2	16	6F	Al	25,47	24,20	32,0	30	36	18	6	11	0,050
36 AT 5/18-2	18	6F	Al	28,65	27,40	32,0	30	36	19	6	12	0,061
36 AT 5/19-2	19	6F	Al	30,25	29,00	36,0	30	36	22	6	12	0,070
36 AT 5/20-2	20	6F	Al	31,83	30,60	36,0	30	36	23	6	14	0,076
36 AT 5/22-2	22	6F	Al	35,12	33,85	38,0	30	36	24	6	15	0,080
36 AT 5/24-2	24	6F	Al	38,21	37,00	42,0	30	36	26	8	15	0,109
36 AT 5/25-2	25	6F	Al	39,80	38,60	44,0	30	36	26	8	15	0,116
36 AT 5/26-2	26	6F	Al	41,47	40,20	44,0	30	36	26	8	16	0,120
36 AT 5/27-2	27	6F	Al	42,98	41,80	48,0	30	36	30	8	18	0,128
36 AT 5/28-2	28	6F	Al	44,62	43,35	48,0	30	36	32	8	18	0,135
36 AT 5/30-2	30	6F	Al	47,76	46,55	51,0	30	36	34	8	18	0,150
36 AT 5/32-2	32	6F	Al	50,94	49,70	54,0	30	36	38	8	22	0,176
36 AT 5/36-2	36	6F	Al	57,31	56,05	63,0	30	36	38	8	22	0,230
36 AT 5/40-2	40	6F	Al	63,66	62,45	66,0	30	36	40	8	23	0,276
36 AT 5/42-2	42	6F	Al	66,87	65,60	71,0	30	36	40	8	24	0,284
36 AT 5/44-0	44	6	Al	70,07	68,80	—	30	36	45	8	26	0,315
36 AT 5/48-0	48	6	Al	76,42	75,15	—	30	36	50	8	28	0,400
36 AT 5/60-0	60	6	Al	95,52	94,25	—	30	36	65	8	35	0,614

Metrische Zahnscheiben für zylindrische Bohrung *Metric timing belt pulleys for plain boring*

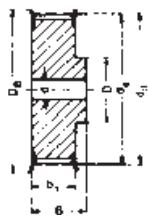

Ausf. Type 6F



Ausf. Type 6

Type AT 10 – Teilung *Pitch 10 mm* für Riemenbreite *for belt width 16 mm*

Bezeichnung <i>Part no.</i>	Anzahl der Zähne <i>No. of teeth</i>	Aus- führung Type	Material	d_d (mm)	d_a (mm)	D_B (mm)	b_1 (mm)	B (mm)	D (mm)	Vor- bohrung <i>Pilot bore d</i> (mm)	Fertig- bohrung <i>Finished bore d_{max}</i> (mm)	Gewicht <i>Weight</i> (= kg)
31 AT 10/15-2	15	6F	Al	47,75	45,90	51	21	31	32	8	18	0,116
31 AT 10/16-2	16	6F	Al	50,93	49,05	54	21	31	35	8	20	0,134
31 AT 10/18-2	18	6F	Al	57,29	55,45	60	21	31	40	8	22	0,167
31 AT 10/19-2	19	6F	Al	60,48	58,60	66	21	31	44	8	22	0,184
31 AT 10/20-2	20	6F	Al	63,66	61,80	66	21	31	46	8	24	0,208
31 AT 10/22-2	22	6F	Al	70,03	68,15	75	21	31	52	8	28	0,253
31 AT 10/24-2	24	6F	Al	76,39	74,55	83	21	31	58	8	30	0,288
31 AT 10/25-2	25	6F	Al	79,58	77,70	83	21	31	60	8	30	0,310
31 AT 10/26-2	26	6F	Al	82,76	80,90	87	21	31	60	8	30	0,357
31 AT 10/27-2	27	6F	Al	85,95	84,10	91	21	31	60	8	30	0,364
31 AT 10/28-2	28	6F	Al	89,13	87,25	93	21	31	60	8	30	0,401
31 AT 10/30-2	30	6F	Al	95,49	93,65	97	21	31	60	8	30	0,441
31 AT 10/32-2	32	6F	Al	101,86	100,00	106	21	31	65	10	32	0,493
31 AT 10/36-2	36	6F	Al	114,59	112,75	119	21	31	70	10	35	0,623
31 AT 10/40-2	40	6F	Al	127,32	125,45	131	21	31	80	10	40	0,767
31 AT 10/44-0	44	6	Al	140,06	138,20	—	21	31	88	10	46	0,993
31 AT 10/48-0	48	6	Al	152,78	150,95	—	21	31	95	16	48	1,090
31 AT 10/60-0	60	6	Al	190,98	189,10	—	21	31	110	16	60	1,710

Type AT 10 – Teilung *Pitch 10 mm* für Riemenbreite *for belt width 25 mm*

40 AT 10/15-2	15	6F	Al	47,75	45,90	51	30	40	32	8	18	0,152
40 AT 10/16-2	16	6F	Al	50,93	49,05	54	30	40	35	8	20	0,176
40 AT 10/18-2	18	6F	Al	57,29	55,45	60	30	40	40	8	22	0,224
40 AT 10/19-2	19	6F	Al	60,48	58,60	66	30	40	44	8	22	0,247
40 AT 10/20-2	20	6F	Al	63,66	61,80	66	30	40	46	8	24	0,276
40 AT 10/22-2	22	6F	Al	70,03	68,15	75	30	40	52	8	28	0,337
40 AT 10/24-2	24	6F	Al	76,39	74,55	83	30	40	58	8	30	0,392
40 AT 10/25-2	25	6F	Al	79,58	77,70	83	30	40	60	8	30	0,422
40 AT 10/26-2	26	6F	Al	82,76	80,90	87	30	40	60	8	30	0,477
40 AT 10/27-2	27	6F	Al	85,95	84,10	91	30	40	60	8	30	0,536
40 AT 10/28-2	28	6F	Al	89,13	87,25	93	30	40	60	8	30	0,540
40 AT 10/30-2	30	6F	Al	95,49	93,65	97	30	40	60	8	30	0,640
40 AT 10/32-2	32	6F	Al	101,86	100,00	106	30	40	65	10	32	0,693
40 AT 10/36-2	36	6F	Al	114,59	112,75	119	30	40	70	10	35	0,873
40 AT 10/40-2	40	6F	Al	127,32	125,45	131	30	40	80	10	40	1,067
40 AT 10/44-0	44	6	Al	140,06	138,20	—	30	40	88	10	46	1,350
40 AT 10/48-0	48	6	Al	152,78	150,95	—	30	40	95	16	48	1,516
40 AT 10/60-0	60	6	Al	190,98	189,10	—	30	40	110	16	60	2,339

Metrische Zahnscheiben für zylindrische Bohrung *Metric timing belt pulleys for plain boring*

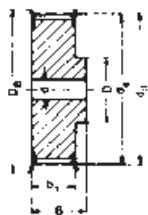

Ausf. Type 6F



Ausf. Type 6

Type AT 10 – Teilung *Pitch 10 mm* für Riemenbreite *for belt width 32 mm*

Bezeichnung <i>Part no.</i>	Anzahl der Zähne <i>No. of teeth</i>	Aus- führung Type	Material	d_d (mm)	d_a (mm)	D_B (mm)	b_1 (mm)	B (mm)	D (mm)	Vor- bohrung <i>Pilot bore d</i> (mm)	Fertig- bohrung <i>Finished bore d_{max}</i> (mm)	Gewicht <i>Weight</i> (= kg)
47 AT 10/18-2	18	6F	Al	57,29	55,45	60	37	47	40	10	22	0,253
47 AT 10/19-2	19	6F	Al	60,48	58,60	66	37	47	44	10	22	0,286
47 AT 10/20-2	20	6F	Al	63,66	61,80	66	37	47	46	12	24	0,322
47 AT 10/22-2	22	6F	Al	70,03	68,15	75	37	47	52	12	28	0,393
47 AT 10/24-2	24	6F	Al	76,39	74,55	83	37	47	58	12	30	0,475
47 AT 10/25-2	25	6F	Al	79,58	77,70	83	37	47	60	12	30	0,527
47 AT 10/26-2	26	6F	Al	82,76	80,90	87	37	47	60	12	30	0,564
47 AT 10/27-2	27	6F	Al	85,95	84,10	91	37	47	60	12	30	0,602
47 AT 10/28-2	28	6F	Al	89,13	87,25	93	37	47	60	12	30	0,642
47 AT 10/30-2	30	6F	Al	95,49	93,65	97	37	47	60	12	30	0,740
47 AT 10/32-2	32	6F	Al	101,86	100,00	106	37	47	65	12	32	0,844
47 AT 10/36-2	36	6F	Al	114,59	112,75	119	37	47	70	16	35	1,083
47 AT 10/40-2	40	6F	Al	127,32	125,45	131	37	47	80	16	40	1,317
47 AT 10/44-0	44	6	Al	140,06	138,20	—	37	47	88	16	46	1,611
47 AT 10/48-0	48	6	Al	152,78	150,95	—	37	47	95	16	48	1,931
47 AT 10/60-0	60	6	Al	190,98	189,10	—	37	47	110	16	60	3,004

Type AT 10 – Teilung *Pitch 10 mm* für Riemenbreite *for belt width 50 mm*

66 AT 10/18-2	18	6F	Al	57,29	55,45	60	56	66	40	10	22	0,422
66 AT 10/19-2	19	6F	Al	60,48	58,60	66	56	66	44	10	22	0,466
66 AT 10/20-2	20	6F	Al	63,66	61,80	66	56	66	46	12	24	0,520
66 AT 10/22-2	22	6F	Al	70,03	68,15	75	56	66	52	12	28	0,570
66 AT 10/24-2	24	6F	Al	76,39	74,55	83	56	66	58	12	30	0,736
66 AT 10/25-2	25	6F	Al	79,58	77,70	83	56	66	60	12	30	0,766
66 AT 10/26-2	26	6F	Al	82,76	80,90	87	56	66	60	12	30	0,816
66 AT 10/27-2	27	6F	Al	85,95	84,10	91	56	66	60	12	30	0,946
66 AT 10/28-2	28	6F	Al	89,13	87,25	93	56	66	60	12	30	0,960
66 AT 10/30-2	30	6F	Al	95,49	93,65	97	56	66	60	12	30	1,169
66 AT 10/32-2	32	6F	Al	101,86	100,00	106	56	66	65	12	32	1,300
66 AT 10/36-2	36	6F	Al	114,59	112,75	119	56	66	70	16	35	1,637
66 AT 10/40-2	40	6F	Al	127,32	125,45	131	56	66	80	16	40	1,999
66 AT 10/44-0	44	6	Al	140,06	138,20	—	56	66	88	16	46	2,357
66 AT 10/48-0	48	6	Al	152,78	150,95	—	56	66	95	16	48	2,830
66 AT 10/60-0	60	6	Al	190,98	189,10	—	56	66	110	16	60	4,366